

Soils Map

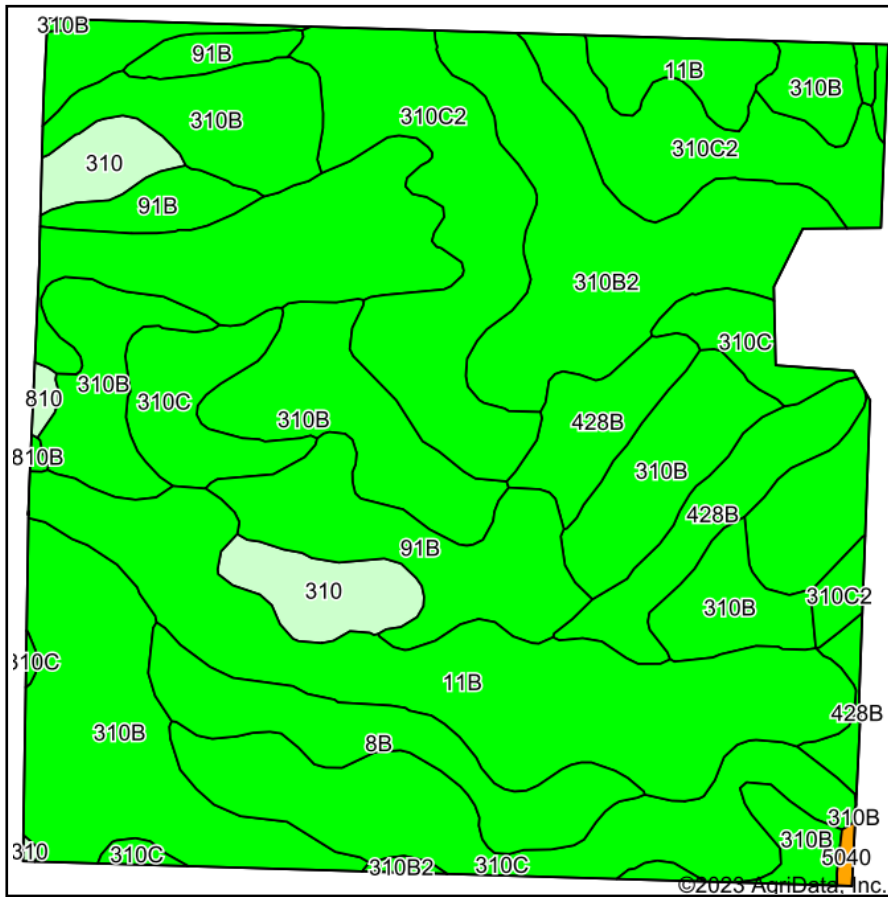

Soils data provided by USDA and NRCS.

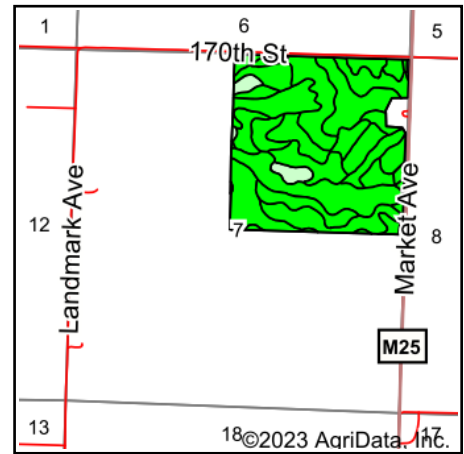

State: **Iowa**
 County: **Ida**
 Location: **7-88N-39W**
 Township: **Silver Creek**
 Acres: **151.32**
 Date: **6/14/2023**

MIDWEST LAND & REAL ESTATE, INC.
 712-262-3110 MANAGEMENT
 Maps Provided By:
surety
 CUSTOMIZED ONLINE MAPPING
 © AgriData, Inc. 2023 www.AgriDataInc.com

Area Symbol: IA093, Soil Area Version: 33

Code	Soil Description	Acres	Percent of field	CSR2 Legend	CSR2**	CSR
310B	Galva silty clay loam, 2 to 5 percent slopes	37.06	24.5%		95	73
11B	Colo-Judson silty clay loams, 0 to 5 percent slopes, occasionally flooded	31.87	21.1%		80	62
310C2	Galva silty clay loam, 5 to 9 percent slopes, eroded	18.74	12.4%		84	55
310C	Galva silty clay loam, 5 to 9 percent slopes	17.39	11.5%		87	57
310B2	Galva silty clay loam, 2 to 5 percent slopes, eroded	15.52	10.3%		90	71
91B	Primghar silty clay loam, 2 to 5 percent slopes	10.47	6.9%		95	81
428B	Ely silty clay loam, shallow loess, 2 to 5 percent slopes	8.53	5.6%		88	78
8B	Judson silty clay loam, deep loess, 2 to 5 percent slopes	6.28	4.2%		92	76
310	Galva silty clay loam, 0 to 2 percent slopes	4.86	3.2%		100	78
810	Galva silty clay loam, terrace, 0 to 2 percent slopes	0.31	0.2%		100	78
5040	Udorthents, loamy	0.19	0.1%		5	5
810B	Galva silty clay loam, terrace, 2 to 5 percent slopes	0.10	0.1%		95	73
Weighted Average					88.6	67.5

**IA has updated the CSR values for each county to CSR2.
 Soils data provided by USDA and NRCS.