

Soils Map

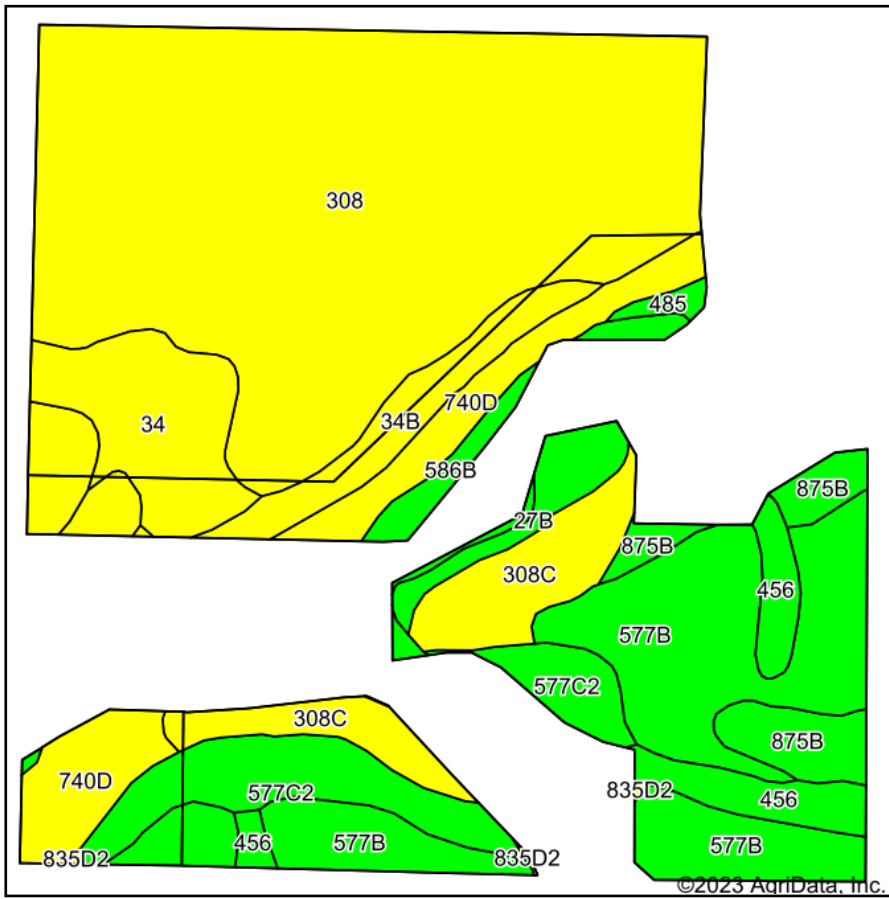

Soils data provided by USDA and NRCS.

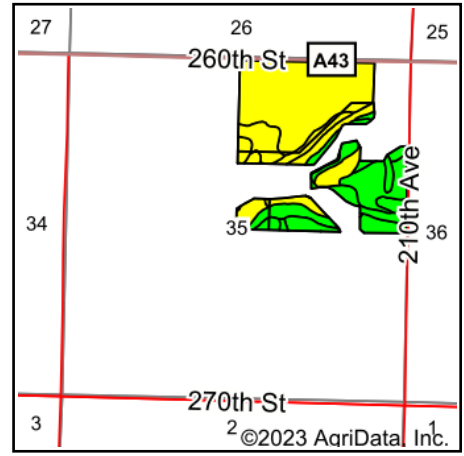

State: **Iowa**
County: **Dickinson**
Location: **35-98N-37W**
Township: **Okoboji**
Acres: **110.23**
Date: **4/27/2023**

MIDWEST LAND & REAL ESTATE, INC.
712-262-3110 MANAGEMENT

Maps Provided By:



Area Symbol: IA059, Soil Area Version: 32

Code	Soil Description	Acres	Percent of field	CSR2 Legend	Non-Irr Class *c	CSR2**	CSR
308	Wadena loam, 0 to 2 percent slopes	48.89	44.4%		Ils	56	43
577B	Everly clay loam, 2 to 5 percent slopes	18.18	16.5%		Ile	91	73
740D	Hawick gravelly sandy loam, 12 to 20 percent slopes	7.56	6.9%		VIls	5	11
577C2	Everly clay loam, 5 to 9 percent slopes, moderately eroded	7.04	6.4%		IIIle	85	67
308C	Wadena loam, 6 to 12 percent slopes	6.59	6.0%		IIIle	47	32
34	Estherville sandy loam, 0 to 2 percent slopes	6.21	5.6%		IIIls	29	15
456	Wilmonton silty clay loam, 1 to 3 percent slopes	3.78	3.4%		Iw	91	73
875B	Roine fine sandy loam, 2 to 5 percent slopes	3.64	3.3%		IIIle	81	63
34B	Estherville sandy loam, 2 to 6 percent slopes	3.62	3.3%		IIIls	27	15
586B	Coland-Spillville complex, 1 to 5 percent slopes, occasionally flooded	2.12	1.9%		IIw	74	55
27B	Terril loam, 2 to 6 percent slopes	2.07	1.9%		Ile	87	71
485	Spillville loam, 0 to 2 percent slopes, occasionally flooded	0.44	0.4%		IIw	88	68
835D2	Omsrud-Storden complex, 10 to 16 percent slopes, moderately eroded	0.09	0.1%		IVe	53	35
Weighted Average					2.56	60.2	46.7

**IA has updated the CSR values for each county to CSR2.

*c: Using Capabilities Class Dominant Condition Aggregation Method

Soils data provided by USDA and NRCS.