

Soils Map

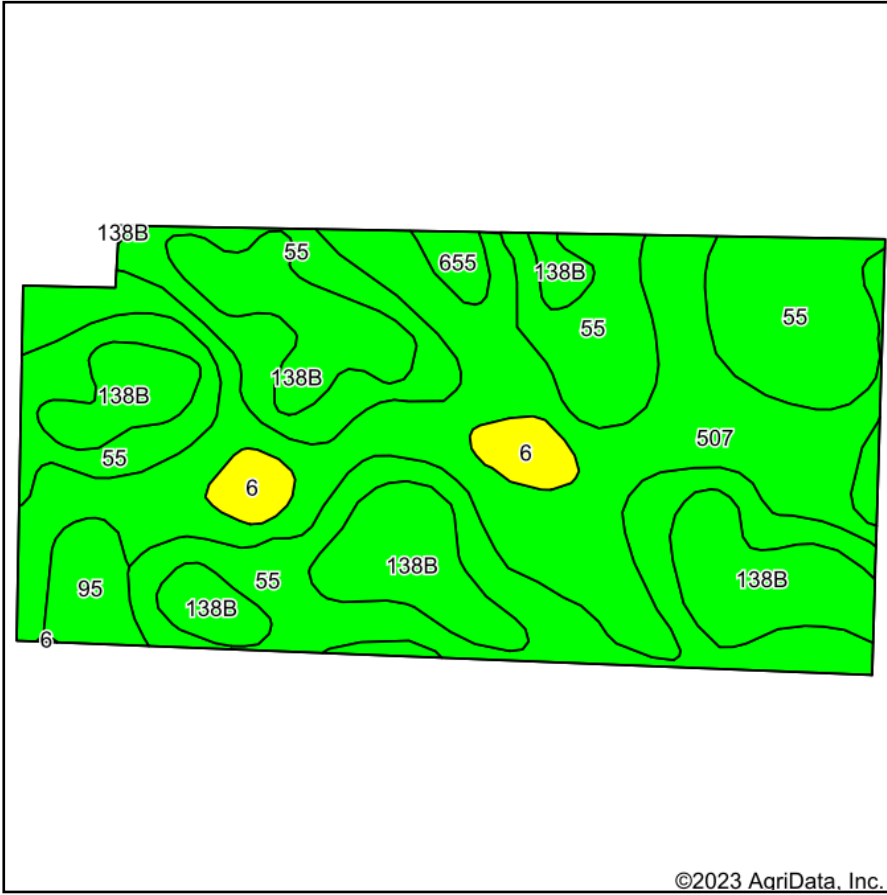

Soils data provided by USDA and NRCS.

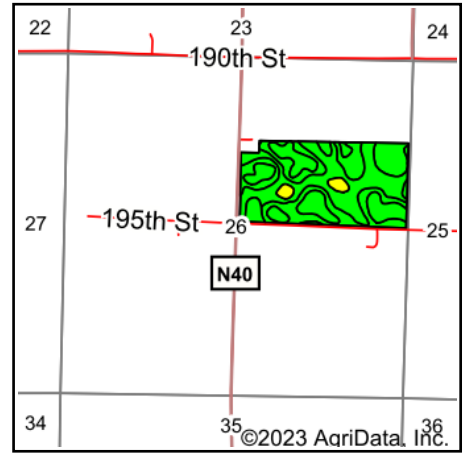

State: **Iowa**
 County: **Emmet**
 Location: **26-99N-33W**
 Township: **Center**
 Acres: **74.78**
 Date: **1/23/2023**

MIDWEST LAND & REAL ESTATE, INC.
 712-262-3110 MANAGEMENT
 Maps Provided By: **surety**
 CUSTOMIZED ONLINE MAPPING
 © AgriData, Inc. 2021 www.AgriDataInc.com

Area Symbol: IA063, Soil Area Version: 32

| Code | Soil Description | Acres | Percent of field | CSR2 Legend | CSR2** | CSR |
|-------------------------|------------------------------------------------|-------|------------------|-------------|-----------|-------------|
| 55 | Nicollet clay loam, 1 to 3 percent slopes | 29.36 | 39.3% | | 89 | 82 |
| 507 | Canisteo clay loam, 0 to 2 percent slopes | 24.72 | 33.1% | | 84 | 73 |
| 138B | Clarion loam, 2 to 6 percent slopes | 15.77 | 21.1% | | 89 | 74 |
| 6 | Okoboji silty clay loam, 0 to 1 percent slopes | 2.17 | 2.9% | | 59 | 53 |
| 95 | Harps clay loam, 0 to 2 percent slopes | 1.99 | 2.7% | | 72 | 57 |
| 655 | Crippin loam, 1 to 3 percent slopes | 0.77 | 1.0% | | 91 | 77 |
| Weighted Average | | | | | 86 | 75.8 |

**IA has updated the CSR values for each county to CSR2.
 Soils data provided by USDA and NRCS.