

# Soils Map

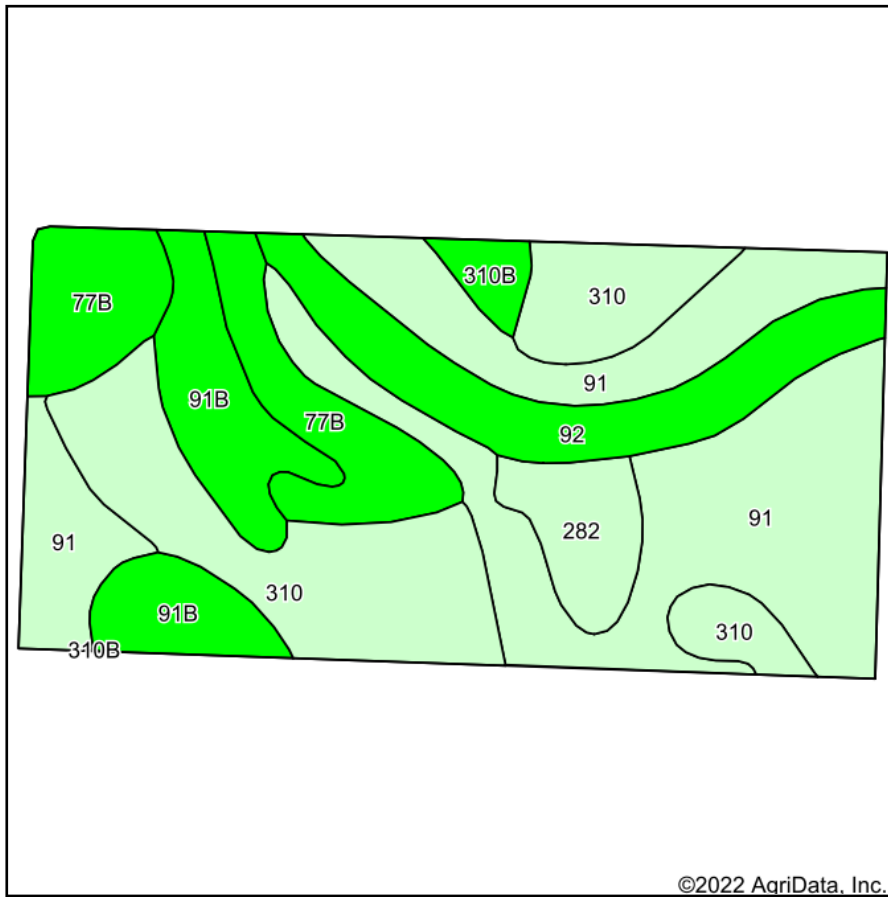

Soils data provided by USDA and NRCS.

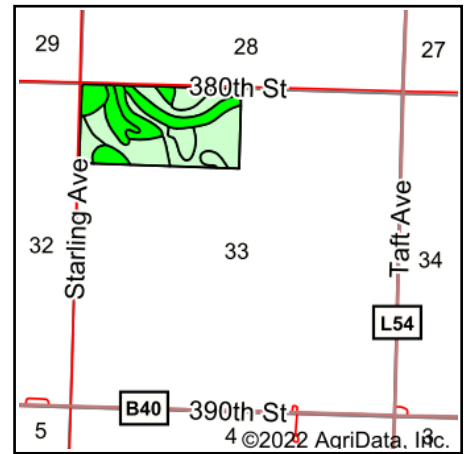

State: **Iowa**  
 County: **O'Brien**  
 Location: **33-96N-40W**  
 Township: **Center**  
 Acres: **77.83**  
 Date: **10/28/2022**

**MIDWEST LAND** & REAL ESTATE, INC  
 712-262-3110 MANAGEMENT  
 Maps Provided By:  
**surety**  
 CUSTOMIZED ONLINE MAPPING  
 © AgriData, Inc. 2021 www.AgriDataInc.com

Area Symbol: IA141, Soil Area Version: 26						
Code	Soil Description	Acres	Percent of field	CSR2 Legend	CSR2**	CSR
91	Primghar silty clay loam, 0 to 2 percent slopes	29.10	37.4%		100	80
310	Galva silty clay loam, 0 to 2 percent slopes	17.24	22.2%		100	75
77B	Sac silty clay loam, loam substratum, 2 to 5 percent slopes	9.48	12.2%		95	68
92	Marcus silty clay loam, 0 to 2 percent slopes	8.61	11.1%		94	75
91B	Primghar silty clay loam, 2 to 5 percent slopes	8.46	10.9%		95	78
282	Ransom silty clay loam, 1 to 3 percent slopes	3.67	4.7%		100	75
310B	Galva silty clay loam, 2 to 5 percent slopes	1.27	1.6%		95	70
Weighted Average					98.1	76.3

\*\*IA has updated the CSR values for each county to CSR2.  
 Soils data provided by USDA and NRCS.