

Soils Map

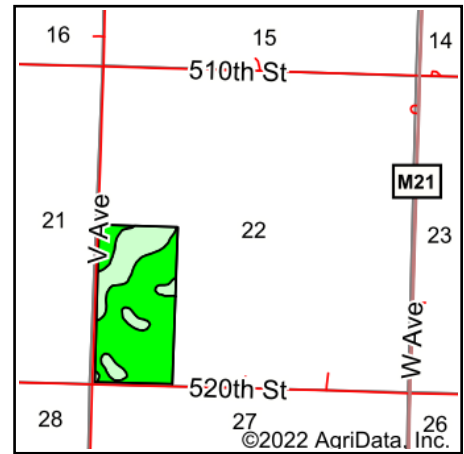

Soils data provided by USDA and NRCS.



State: **Iowa**
 County: **Cherokee**
 Location: **22-92N-39W**
 Township: **Afton**
 Acres: **78**
 Date: **10/6/2022**

MIDWEST LAND & REAL ESTATE, INC.
 712-262-3110 MANAGEMENT
 Maps Provided By:

 CUSTOMIZED ONLINE MAPPING
 © AgriData, Inc. 2021 www.AgriDataInc.com



Area Symbol: IA035, Soil Area Version: 31

Code	Soil Description	Acres	Percent of field	CSR2 Legend	CSR2**	CSR
92	Marcus silty clay loam, 0 to 2 percent slopes	50.02	64.1%		94	76
810	Galva silty clay loam, terrace, 0 to 2 percent slopes	16.82	21.6%		100	76
91	Primghar silty clay loam, 0 to 2 percent slopes	6.07	7.8%		100	81
133	Colo silty clay loam, deep loess, 0 to 2 percent slopes, occasionally flooded	4.85	6.2%		78	74
310	Galva silty clay loam, 0 to 2 percent slopes	0.24	0.3%		100	76
Weighted Average					94.8	76.3

**IA has updated the CSR values for each county to CSR2.
 Soils data provided by USDA and NRCS.