

# Soils Map

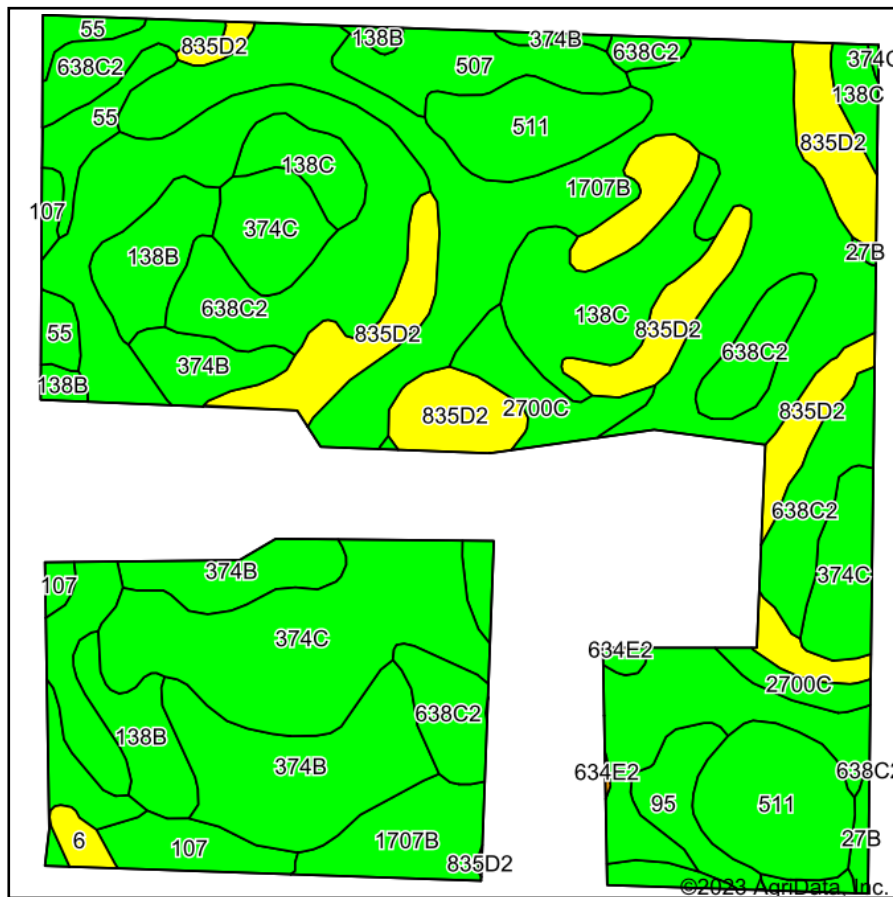

Soils data provided by USDA and NRCS.

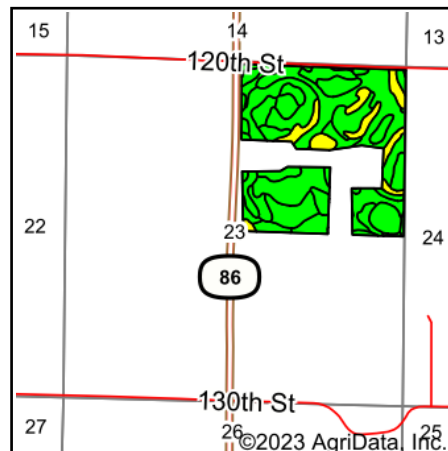

State: **Iowa**  
 County: **Dickinson**  
 Location: **24-100N-37W**  
 Township: **Diamond Lake**  
 Acres: **121.6**  
 Date: **4/11/2023**

**MIDWEST LAND** & REAL ESTATE, INC.  
 712-262-3110 MANAGEMENT  
 Maps Provided By: **surety**  
 CUSTOMIZED ONLINE MAPPING  
 © AgriData, Inc. 2023 www.AgriDataInc.com

Area Symbol: IA059, Soil Area Version: 32

Code	Soil Description	Acres	Percent of field	CSR2 Legend	CSR2**	CSR
1707B	Delft-Terril complex, 1 to 5 percent slopes	28.53	23.5%		78	59
638C2	Clarion-Storden complex, 6 to 10 percent slopes, moderately eroded	21.00	17.3%		75	52
374C	Okabena silty clay loam, 5 to 9 percent slopes	14.03	11.5%		86	69
835D2	Omsrud-Storden complex, 10 to 16 percent slopes, moderately eroded	12.95	10.6%		53	35
374B	Okabena silty clay loam, 1 to 5 percent slopes	10.15	8.3%		91	73
138C	Clarion loam, 6 to 10 percent slopes	7.63	6.3%		84	67
511	Blue Earth mucky silt loam, 0 to 1 percent slopes	7.57	6.2%		66	49
138B	Clarion loam, 2 to 6 percent slopes	5.11	4.2%		89	73
2700C	Ridgeton loam, 5 to 9 percent slopes	3.58	2.9%		84	66
507	Canisteo clay loam, 0 to 2 percent slopes	3.39	2.8%		84	71
55	Nicollet clay loam, 1 to 3 percent slopes	2.50	2.1%		89	73
107	Webster clay loam, 0 to 2 percent slopes	2.34	1.9%		86	70
95	Harps clay loam, 0 to 2 percent slopes	1.82	1.5%		72	57
6	Okoboji silty clay loam, 0 to 1 percent slopes	0.53	0.4%		59	43
27B	Terril loam, 2 to 6 percent slopes	0.47	0.4%		87	71
Weighted Average					77.5	59

\*\*IA has updated the CSR values for each county to CSR2.  
 Soils data provided by USDA and NRCS.