

# Soils Map

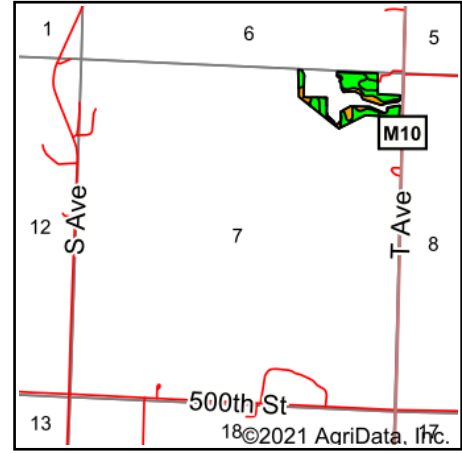

Soils data provided by USDA and NRCS.



State: **Iowa**  
 County: **Cherokee**  
 Location: **7-92N-39W**  
 Township: **Afton**  
 Acres: **12.48**  
 Date: **6/21/2021**

& REAL ESTATE, INC  
**MIDWEST LAND**  
 712-262-3110 MANAGEMENT  
 Maps Provided By:  
  
 CUSTOMIZED ONLINE MAPPING  
 © AgriData, Inc. 2021 www.AgriDataInc.com



Area Symbol: IA035, Soil Area Version: 30

Code	Soil Description	Acres	Percent of field	CSR2 Legend	Non-Irr Class *c	CSR2**	CSR
77C	Sac silty clay loam, loam substratum, 5 to 9 percent slopes	4.02	32.2%		IIIe	90	54
33G	Steinauer clay loam, 25 to 40 percent slopes	3.23	25.9%		VIIe	5	5
310C	Galva silty clay loam, 5 to 9 percent slopes	1.60	12.8%		IIIe	87	56
77B	Sac silty clay loam, loam substratum, 2 to 5 percent slopes	1.60	12.8%		Ile	95	69
77C2	Sac silty clay loam, loam substratum, 5 to 9 percent slopes, eroded	0.83	6.7%		IIIe	88	52
310B	Galva silty clay loam, 2 to 5 percent slopes	0.65	5.2%		Ile	95	71
78C	Sac silty clay loam, 5 to 9 percent slopes	0.55	4.4%		IIIe	84	52
<b>Weighted Average</b>						<b>68.1</b>	<b>44.2</b>

\*\*IA has updated the CSR values for each county to CSR2.

\*c: Using Capabilities Class Dominant Condition Aggregation Method

Soils data provided by USDA and NRCS.