

Soils Map

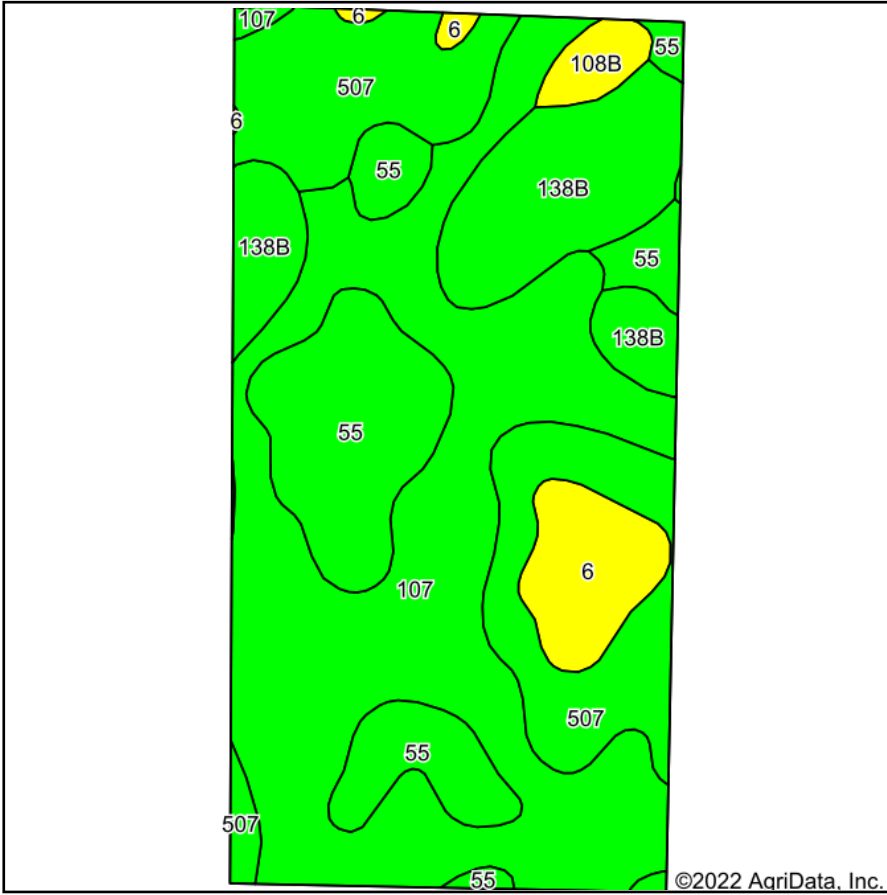

Soils data provided by USDA and NRCS.

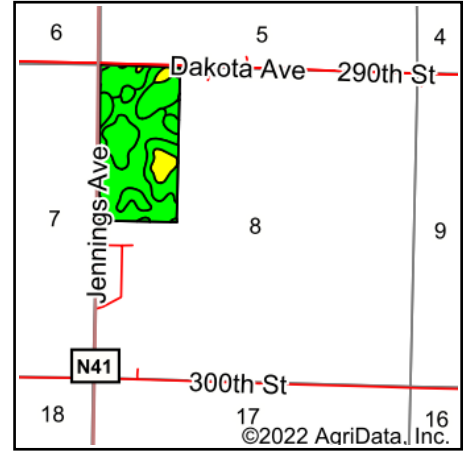

State: **Iowa**
 County: **Calhoun**
 Location: **8-87N-33W**
 Township: **Lake Creek**
 Acres: **79**
 Date: **9/26/2022**

MIDWEST LAND & REAL ESTATE, INC
 712-262-3110 MANAGEMENT

Maps Provided By:

 CUSTOMIZED ONLINE MAPPING
 © AgriData, Inc. 2021 www.AgriDataInc.com



Area Symbol: IA025, Soil Area Version: 31

Code	Soil Description	Acres	Percent of field	CSR2 Legend	CSR2**	CSR
107	Webster clay loam, 0 to 2 percent slopes	33.86	42.9%		86	83
507	Canisteo clay loam, 0 to 2 percent slopes	14.99	19.0%		84	78
55	Nicollet clay loam, 1 to 3 percent slopes	13.59	17.2%		89	88
138B	Clarion loam, 2 to 6 percent slopes	10.96	13.9%		89	80
6	Okoboji silty clay loam, 0 to 1 percent slopes	4.27	5.4%		59	57
108B	Wadena loam, 2 to 6 percent slopes	1.33	1.7%		52	49
Weighted Average					84.5	80.5

**IA has updated the CSR values for each county to CSR2.
 Soils data provided by USDA and NRCS.