

Soils Map

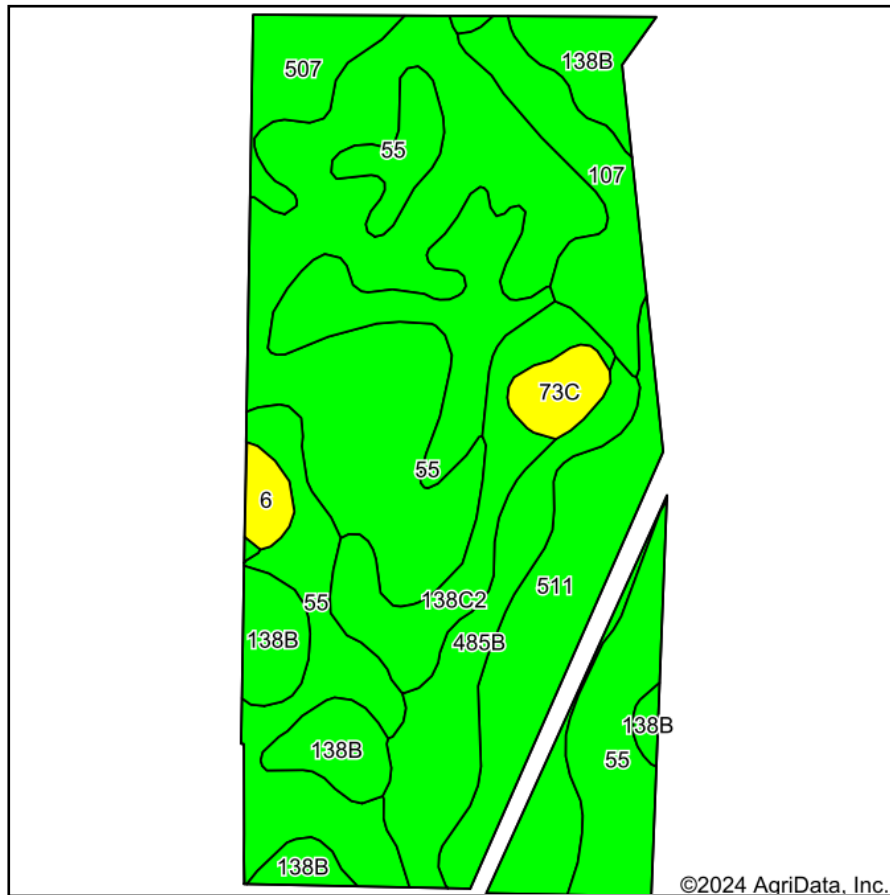

Soils data provided by USDA and NRCS.

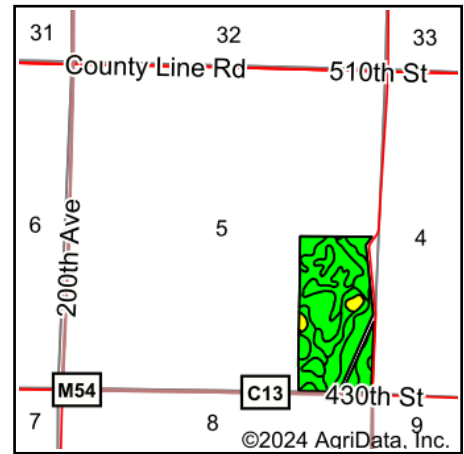

State: **Iowa**
 County: **Buena Vista**
 Location: **5-93N-35W**
 Township: **Poland**
 Acres: **70.89**
 Date: **5/1/2024**



| Area Symbol: IA021, Soil Area Version: 29 | | | | | | | |
|---|---|-------|------------------|-------------|------------------|--------|------|
| Code | Soil Description | Acres | Percent of field | CSR2 Legend | Non-Irr Class *c | CSR2** | CSR |
| 138B | Clarion loam, 2 to 6 percent slopes | 25.08 | 35.4% | | Ile | 89 | 76 |
| 55 | Nicollet clay loam, 1 to 3 percent slopes | 17.56 | 24.8% | | Iw | 89 | 84 |
| 511 | Blue Earth mucky silt loam, 0 to 1 percent slopes | 8.74 | 12.3% | | Illw | 66 | 51 |
| 485B | Spillville loam, 2 to 5 percent slopes | 5.77 | 8.1% | | Ile | 88 | 76 |
| 138C2 | Clarion loam, 6 to 10 percent slopes, moderately eroded | 4.69 | 6.6% | | Illle | 83 | 60 |
| 107 | Webster clay loam, 0 to 2 percent slopes | 4.22 | 6.0% | | Ilw | 86 | 79 |
| 507 | Canisteo clay loam, 0 to 2 percent slopes | 2.72 | 3.8% | | Ilw | 84 | 74 |
| 73C | Hawick gravelly sandy loam, 6 to 12 percent slopes | 1.31 | 1.8% | | IVs | 31 | 5 |
| 6 | Okoboji silty clay loam, 0 to 1 percent slopes | 0.80 | 1.1% | | Illw | 59 | 54 |
| Weighted Average | | | | | 1.99 | 83.9 | 72.4 |

**IA has updated the CSR values for each county to CSR2.

*c: Using Capabilities Class Dominant Condition Aggregation Method