

# Soils Map

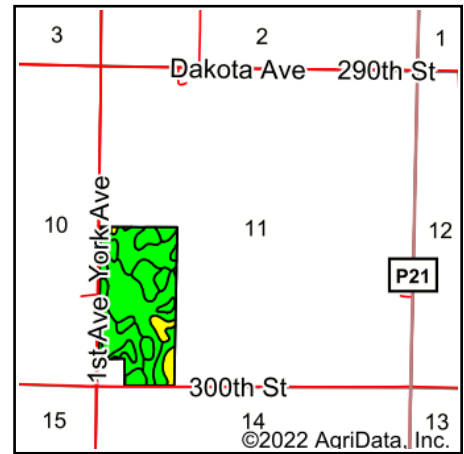
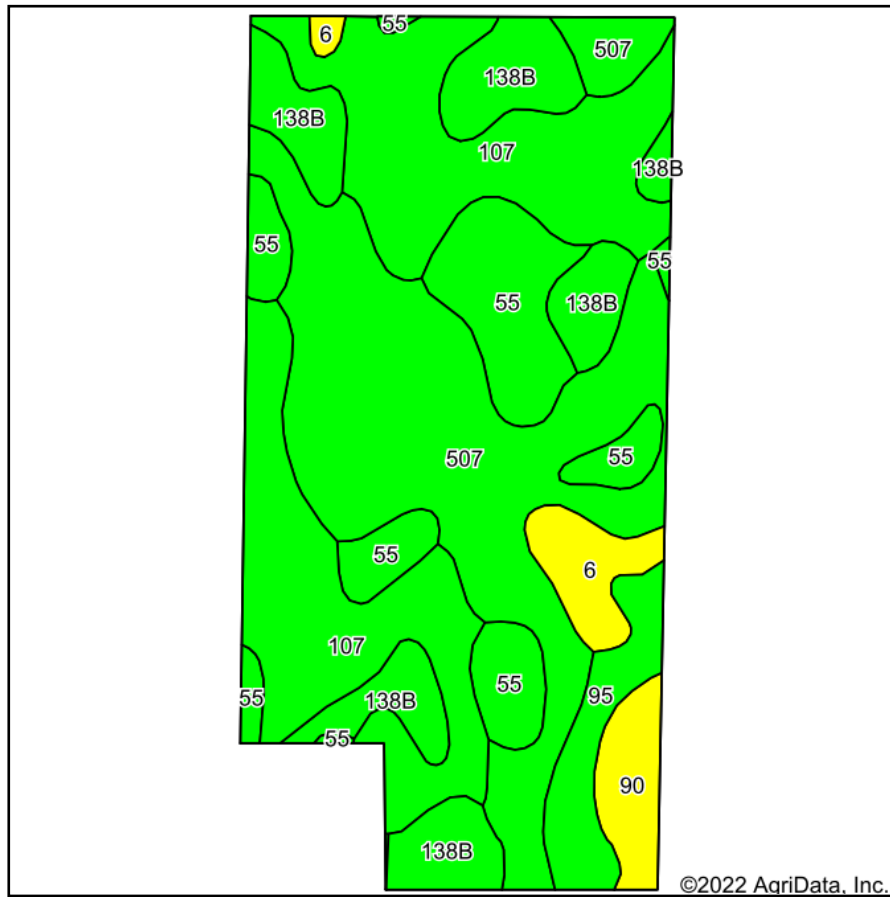

State: **Iowa**  
 County: **Calhoun**  
 Location: **10-87N-31W**  
 Township: **Cedar**  
 Acres: **72.21**  
 Date: **5/12/2022**

**MIDWEST LAND** & REAL ESTATE, INC.  
 712-262-3110 MANAGEMENT  
 Maps Provided By:  
**surety**  
 CUSTOMIZED ONLINE MAPPING  
 © AgriData, Inc. 2021 www.AgriDataInc.com

Area Symbol: IA025, Soil Area Version: 31

Code	Soil Description	Acres	Percent of field	CSR2 Legend	CSR2**	CSR
507	Canisteo clay loam, 0 to 2 percent slopes	22.41	31.0%		84	78
107	Webster clay loam, 0 to 2 percent slopes	21.89	30.3%		86	83
138B	Clarion loam, 2 to 6 percent slopes	9.97	13.8%		89	80
55	Nicollet clay loam, 1 to 3 percent slopes	9.88	13.7%		89	88
95	Harps clay loam, 0 to 2 percent slopes	3.28	4.5%		72	62
6	Okoboji silty clay loam, 0 to 1 percent slopes	2.50	3.5%		59	57
90	Okoboji mucky silt loam, 0 to 1 percent slope	2.28	3.2%		55	59
Weighted Average					83.7	79.1

\*\*IA has updated the CSR values for each county to CSR2.  
 Soils data provided by USDA and NRCS.