

Soils Map

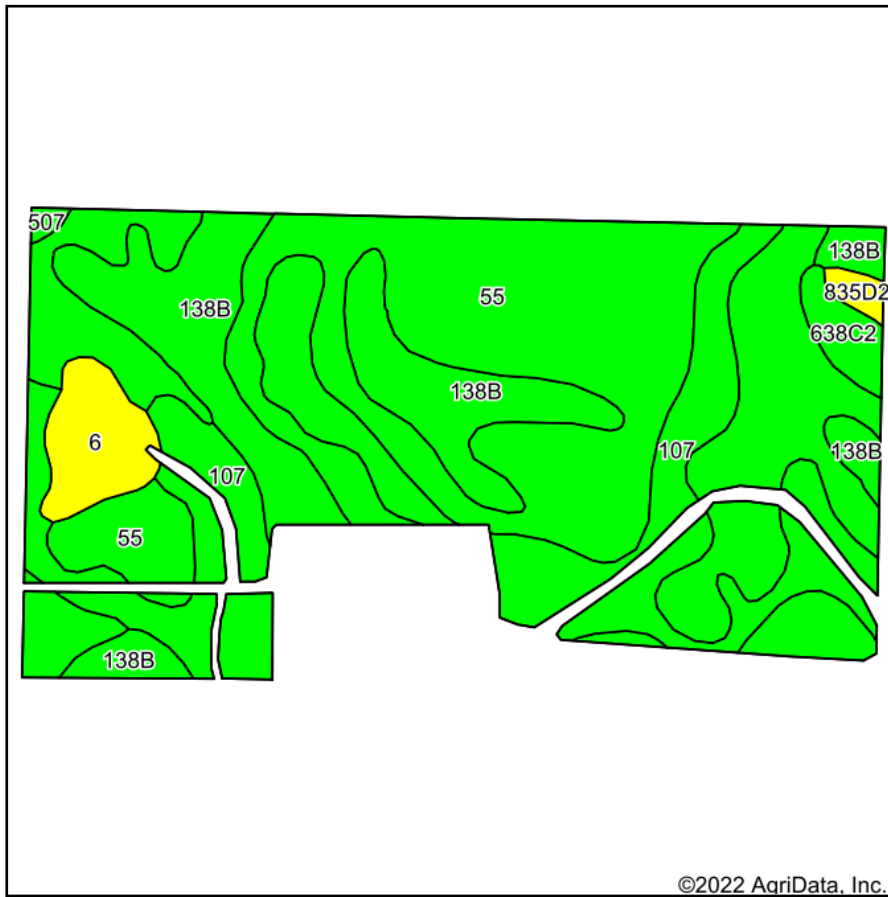

Soils data provided by USDA and NRCS.

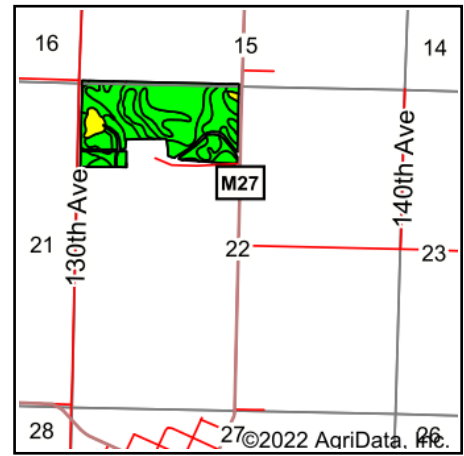

State: **Iowa**
 County: **Dickinson**
 Location: **22-100N-38W**
 Township: **Silver Lake**
 Acres: **69.43**
 Date: **5/19/2022**

MIDWEST LAND & REAL ESTATE, INC.
 712-262-3110 MANAGEMENT
 Maps Provided By:

 CUSTOMIZED ONLINE MAPPING
 © AgriData, Inc. 2021 www.AgriDataInc.com



Area Symbol: IA059, Soil Area Version: 31							
Code	Soil Description	Acres	Percent of field	CSR2 Legend	Non-Irr Class *c	CSR2**	CSR
55	Nicollet clay loam, 1 to 3 percent slopes	36.39	52.4%		Iw	89	73
107	Webster clay loam, 0 to 2 percent slopes	16.40	23.6%		IIw	86	70
138B	Clarion loam, 2 to 6 percent slopes	12.14	17.5%		IIe	89	73
6	Okoboji silty clay loam, 0 to 1 percent slopes	2.71	3.9%		IIIw	59	43
638C2	Clarion-Storden complex, 6 to 10 percent slopes, moderately eroded	1.17	1.7%		IIIe	75	52
835D2	Omsrud-Storden complex, 10 to 16 percent slopes, moderately eroded	0.43	0.6%		IVe	53	35
507	Canisteo clay loam, 0 to 2 percent slopes	0.19	0.3%		IIw	84	71
Weighted Average					1.54	86.6	70.5

**IA has updated the CSR values for each county to CSR2.

*c: Using Capabilities Class Dominant Condition Aggregation Method
 Soils data provided by USDA and NRCS.