

# Soils Map

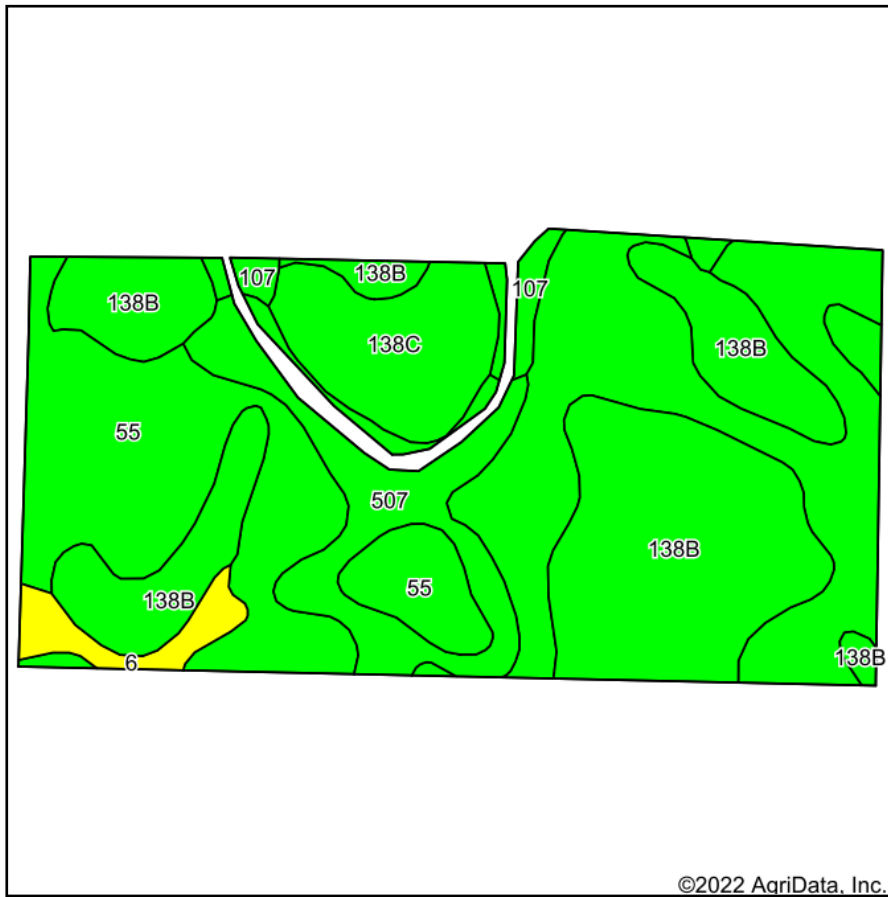

Soils data provided by USDA and NRCS.

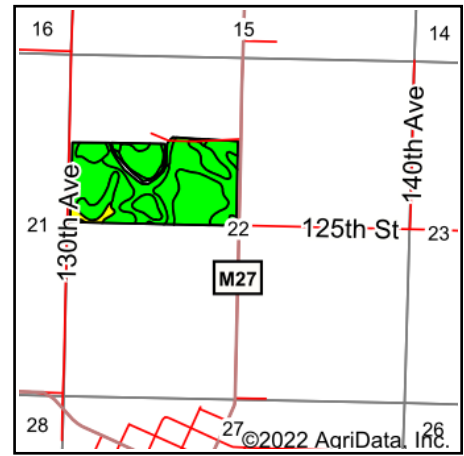

State: **Iowa**  
 County: **Dickinson**  
 Location: **22-100N-38W**  
 Township: **Silver Lake**  
 Acres: **73.99**  
 Date: **5/19/2022**

**MIDWEST LAND** & REAL ESTATE, INC.  
 712-262-3110 **MANAGEMENT**

Maps Provided By:



© AgriData, Inc. 2021

www.AgriDataInc.com



Area Symbol: IA059, Soil Area Version: 31

Code	Soil Description	Acres	Percent of field	CSR2 Legend	Non-Irr Class *c	CSR2**	CSR
55	Nicollet clay loam, 1 to 3 percent slopes	33.25	44.9%		Iw	89	73
138B	Clarion loam, 2 to 6 percent slopes	23.33	31.5%		Ile	89	73
507	Canisteo clay loam, 0 to 2 percent slopes	7.42	10.0%		IIw	84	71
138C	Clarion loam, 6 to 10 percent slopes	5.97	8.1%		IIIe	84	67
107	Webster clay loam, 0 to 2 percent slopes	2.24	3.0%		IIw	86	70
6	Okoboji silty clay loam, 0 to 1 percent slopes	1.78	2.4%		IIIw	59	43
Weighted Average					1.66	87.3	71.5

\*\*IA has updated the CSR values for each county to CSR2.

\*c: Using Capabilities Class Dominant Condition Aggregation Method

Soils data provided by USDA and NRCS.