

# Soils Map

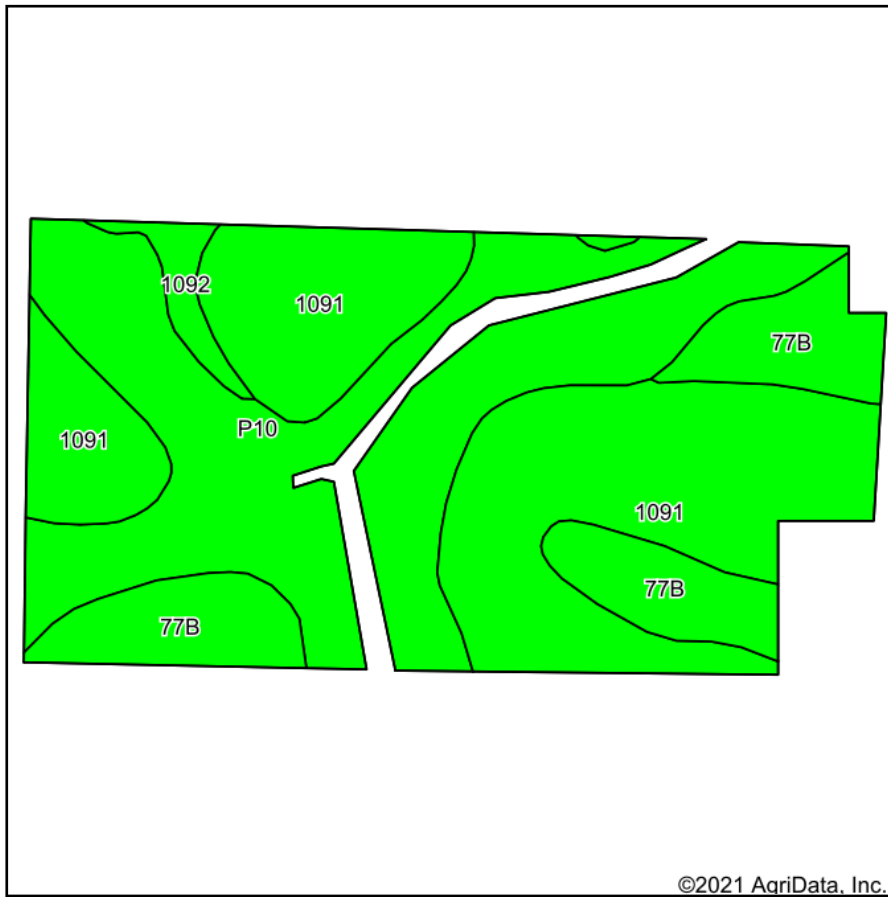

Soils data provided by USDA and NRCS.

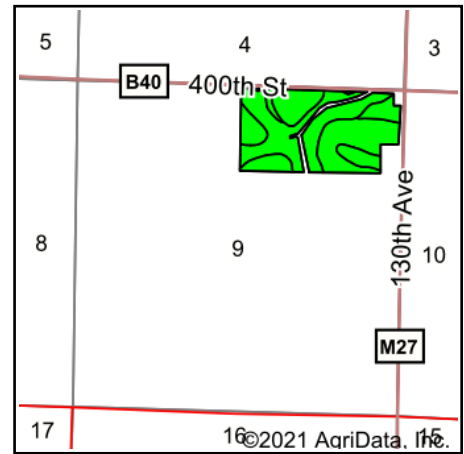

State: **Iowa**  
 County: **Clay**  
 Location: **9-95N-38W**  
 Township: **Clay**  
 Acres: **70.7**  
 Date: **12/2/2021**

**MIDWEST LAND** & REAL ESTATE, INC.  
 712-262-3110 MANAGEMENT  
 Maps Provided By:  
  
 CUSTOMIZED ONLINE MAPPING  
 © AgriData, Inc. 2021 www.AgriDataInc.com



Area Symbol: IA041, Soil Area Version: 31							
Code	Soil Description	Acres	Percent of field	CSR2 Legend	Non-Irr Class *c	CSR2**	CSR
1091	McCreath silty clay loam, 0 to 2 percent slopes	29.82	42.2%		Iw	98	83
P10	Afton silty clay loam, Sheldon creek formation, 0 to 2 percent slopes, occasionally flooded	27.77	39.3%		Ilw	82	
77B	Sac silty clay loam, loam substratum, 2 to 5 percent slopes	11.66	16.5%		Ile	95	71
1092	Gillett Grove silty clay loam, 0 to 2 percent slopes	1.45	2.1%		Ilw	94	78
Weighted Average					1.58	91.1	*.

\*\*IA has updated the CSR values for each county to CSR2.

\*. CSR weighted average cannot be calculated on the current soils data, use prior data version for csr values.

\*c: Using Capabilities Class Dominant Condition Aggregation Method

Soils data provided by USDA and NRCS.