

Soils Map

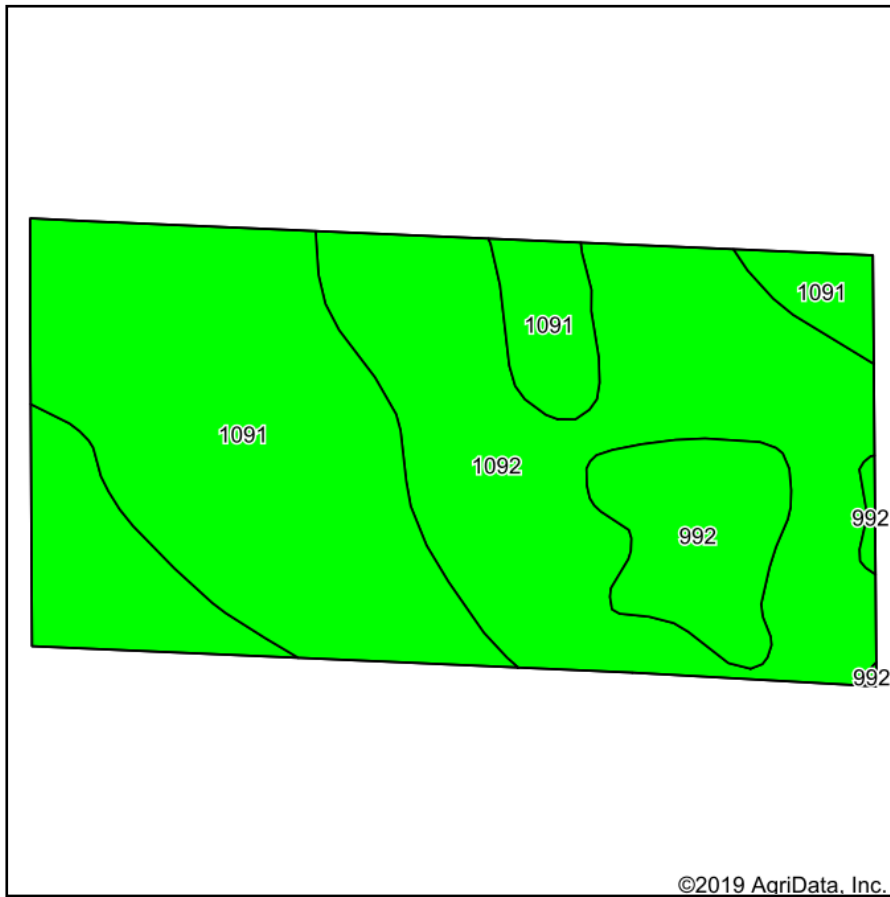

Soils data provided by USDA and NRCS.

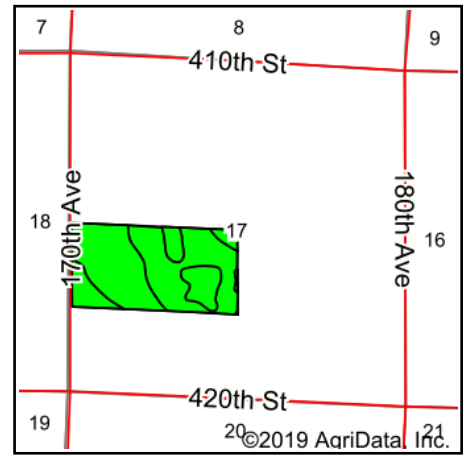

State: **Iowa**
 County: **Clay**
 Location: **17-95N-37W**
 Township: **Lincoln**
 Acres: **79.45**
 Date: **4/29/2020**

MIDWEST LAND & REAL ESTATE, INC.
 712-262-3110 MANAGEMENT
 Maps Provided By:

 © AgriData, Inc. 2019 www.AgriDataInc.com

| Area Symbol: IA041, Soil Area Version: 29 | | | | | | | |
|---|--|-------|------------------|-------------|------------------|--------|------|
| Code | Soil Description | Acres | Percent of field | CSR2 Legend | Non-Irr Class *c | CSR2** | CSR |
| 1092 | Gillett Grove silty clay loam, 0 to 2 percent slopes | 38.56 | 48.5% | | IIw | 94 | 78 |
| 1091 | McCreath silty clay loam, 0 to 2 percent slopes | 33.33 | 42.0% | | Iw | 98 | 83 |
| 992 | Gillett Grove silty clay loam, depressional, 0 to 1 percent slopes | 7.56 | 9.5% | | IIIw | 77 | 58 |
| Weighted Average | | | | | | 94.1 | 78.2 |

**IA has updated the CSR values for each county to CSR2.

*c: Using Capabilities Class Dominant Condition Aggregation Method
 Soils data provided by USDA and NRCS.