

# Soils Map

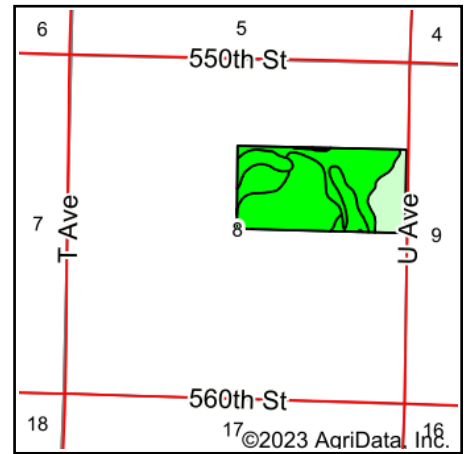

State: **Iowa**  
 County: **Cherokee**  
 Location: **8-91N-39W**  
 Township: **Pitcher**  
 Acres: **77.58**  
 Date: **12/20/2023**

**MIDWEST LAND** & REAL ESTATE, INC.  
 712-262-3110 MANAGEMENT  
 Maps Provided By:  
**surety**  
 CUSTOMIZED ONLINE MAPPING  
 © AgriData, Inc. 2023 www.AgriDataInc.com

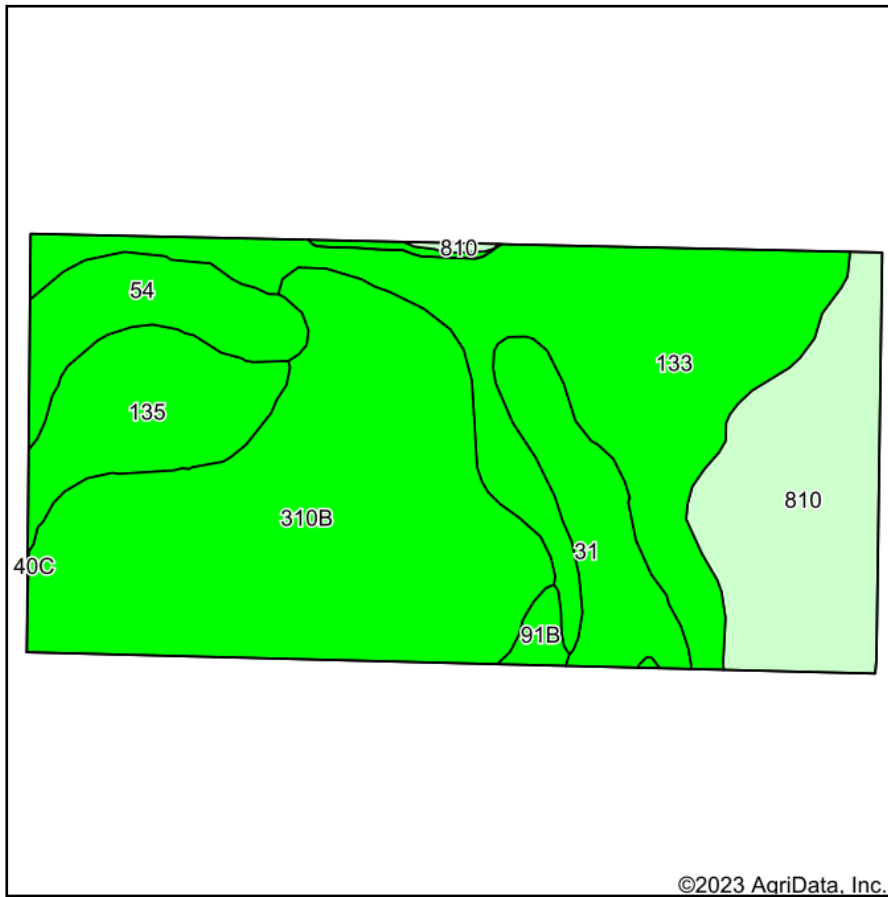

Area Symbol: IA035, Soil Area Version: 33						
Code	Soil Description	Acres	Percent of field	CSR2 Legend	CSR2**	CSR
310B	Galva silty clay loam, 2 to 5 percent slopes	27.27	35.2%		95	71
133	Colo silty clay loam, deep loess, 0 to 2 percent slopes, occasionally flooded	20.78	26.8%		78	74
810	Galva silty clay loam, terrace, 0 to 2 percent slopes	12.11	15.6%		100	76
135	Coland clay loam, 0 to 2 percent slopes	6.46	8.3%		74	74
31	Afton silty clay loam, 0 to 2 percent slopes, occasionally flooded	5.42	7.0%		80	73
54	Zook silty clay loam, 0 to 2 percent slopes, occasionally flooded	4.86	6.3%		67	64
91B	Primghar silty clay loam, 2 to 5 percent slopes	0.68	0.9%		95	79
Weighted Average					86.7	72.6

\*\*IA has updated the CSR values for each county to CSR2.  
 Soils data provided by USDA and NRCS.