

Soils Map

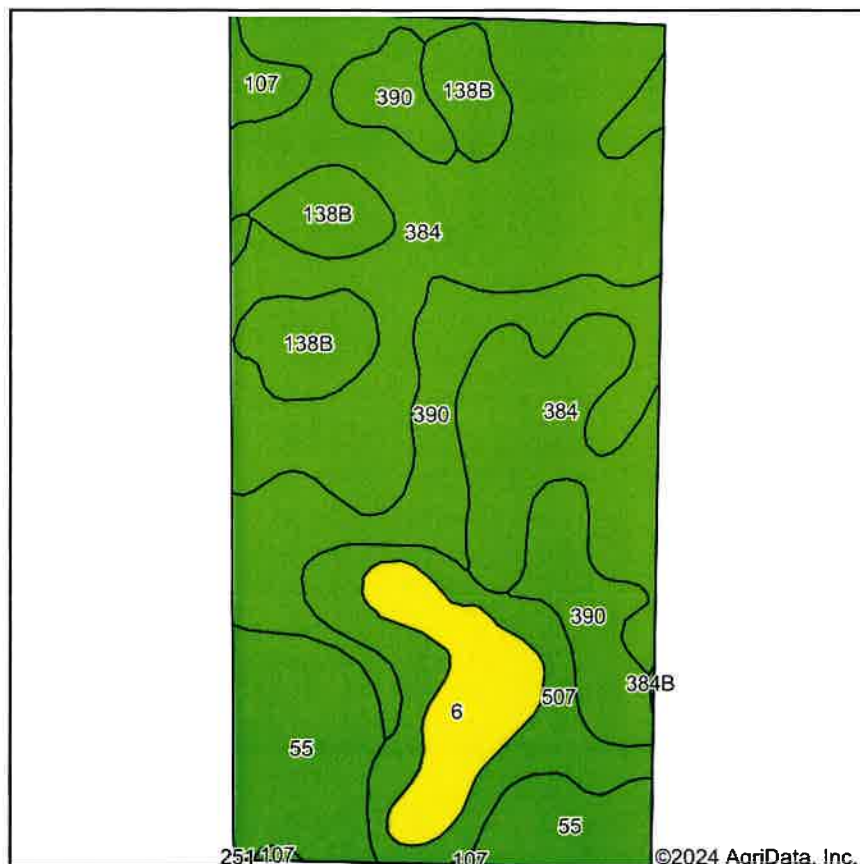

Soils data provided by USDA and NRCS.

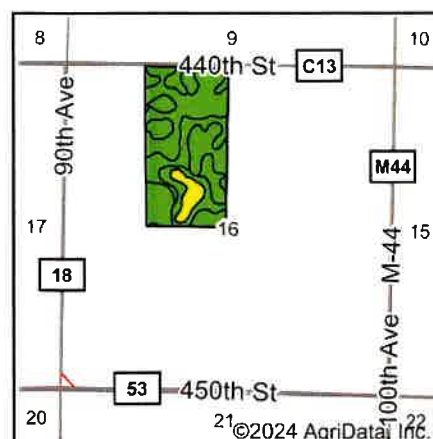

State: **Iowa**
County: **Buena Vista**
Location: **16-93N-37W**
Township: **Barnes**
Acres: **77.51**
Date: **7/18/2024**

MIDWEST LAND

712-262-3110



Area Symbol: IA021, Soil Area Version: 29

Code	Soil Description	Acres	Percent of field	CSR2 Legend	CSR2**	CSR
384	Collinwood silty clay loam, 1 to 3 percent slopes	31.51	40.6%		82	71
390	Waldorf silty clay loam, 0 to 2 percent slopes	16.76	21.6%		69	64
55	Nicollet clay loam, 1 to 3 percent slopes	9.52	12.3%		89	84
507	Canisteo clay loam, 0 to 2 percent slopes	7.39	9.5%		84	74
138B	Clarion loam, 2 to 6 percent slopes	6.24	8.1%		89	76
6	Okoboji silty clay loam, 0 to 1 percent slopes	4.88	6.3%		59	54
107	Webster clay loam, 0 to 2 percent slopes	1.21	1.6%		86	79
Weighted Average					79.4	70.8

**IA has updated the CSR values for each county to CSR2.

Tract 8

Soils Map

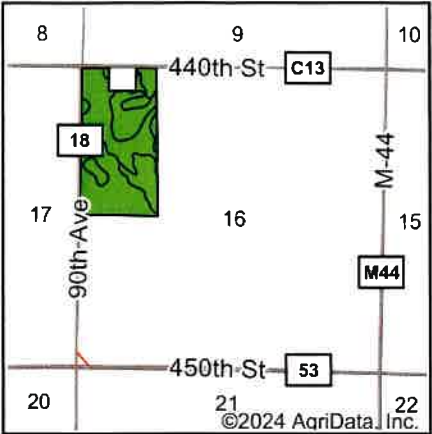

State: Iowa
County: Buena Vista
Location: 16-93N-37W
Township: Barnes
Acres: 74
Date: 7/18/2024

& REAL ESTATE, INC
MIDWEST LAND
712-262-3110 MANAGEMENT

Maps Provided By:
surety
CUSTOMIZED ONLINE MAPPING
© AgriData, Inc. 2023 www.AgriDataInc.com



Soils data provided by USDA and NRCS.

Area Symbol: IA021, Soil Area Version: 29						
Code	Soil Description	Acres	Percent of field	CSR2 Legend	CSR2**	CSR
390	Waldorf silty clay loam, 0 to 2 percent slopes	24.91	33.6%		69	64
251	Nicollet silty clay loam, 1 to 3 percent slopes	22.63	30.6%		86	84
384	Collinwood silty clay loam, 1 to 3 percent slopes	11.78	15.9%		82	71
55	Nicollet clay loam, 1 to 3 percent slopes	7.70	10.4%		89	84
138B	Clarion loam, 2 to 6 percent slopes	4.20	5.7%		89	76
107	Webster clay loam, 0 to 2 percent slopes	2.78	3.8%		86	79
Weighted Average					80.1	74.6

**IA has updated the CSR values for each county to CSR2.