

Soils Map

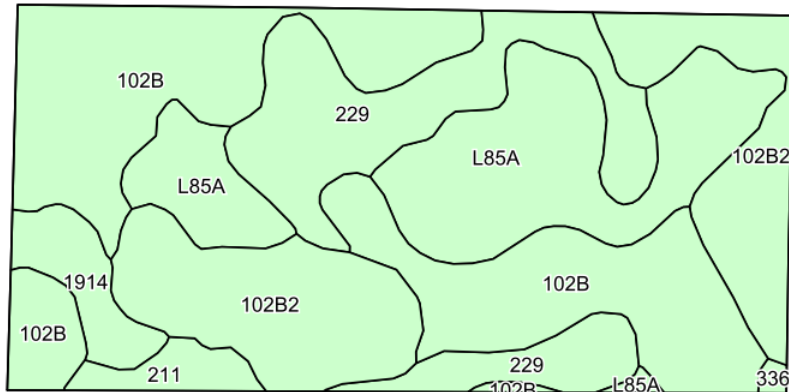

©2022 AgriData, Inc.

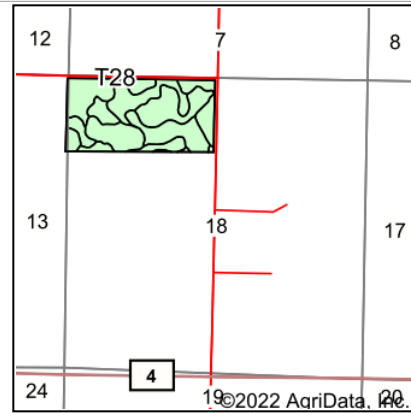

State: **Minnesota**
 County: **Jackson**
 Location: **18-101N-37W**
 Township: **Sioux Valley**
 Acres: **77**
 Date: **7/12/2022**

& REAL ESTATE, INC
MIDWEST LAND
 712-262-3110 MANAGEMENT

Maps Provided By:



© AgriData, Inc. 2021

www.AgriDataInc.com



Soils data provided by USDA and NRCS.

Area Symbol: MN063, Soil Area Version: 18				
Code	Soil Description	Acres	Percent of field	Productivity Index
102B	Clarion loam, 2 to 6 percent slopes	26.29	34.1%	95
L85A	Nicollet clay loam, 1 to 3 percent slopes	16.36	21.2%	99
102B2	Clarion loam, 2 to 6 percent slopes, moderately eroded	16.30	21.2%	95
229	Waldorf silty clay loam, 0 to 2 percent slopes	13.26	17.2%	85
1914	Lura silty clay, nearly level	2.86	3.7%	81
211	Lura silty clay, 0 to 1 percent slopes	1.71	2.2%	81
336	Delft clay loam, 0 to 2 percent slopes	0.22	0.3%	94
Weighted Average				93.3

Soils data provided by USDA and NRCS.