

# Soils Map

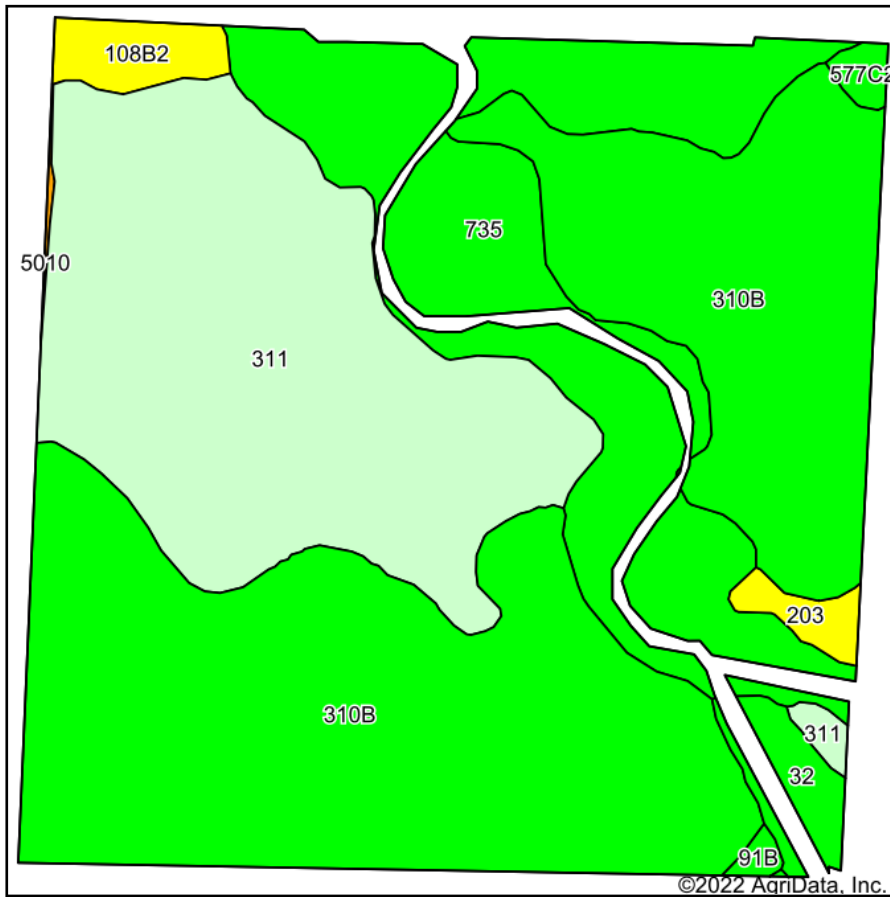

Soils data provided by USDA and NRCS.

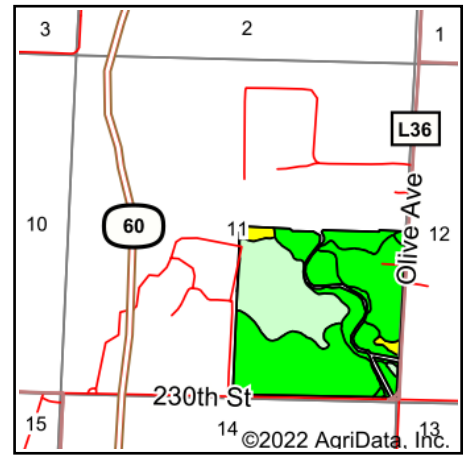

State: **Iowa**  
 County: **Osceola**  
 Location: **11-98N-42W**  
 Township: **Gilman**  
 Acres: **151.56**  
 Date: **1/3/2022**

**MIDWEST LAND** & REAL ESTATE, INC.  
 712-262-3110 MANAGEMENT  
 Maps Provided By: **surety**  
 CUSTOMIZED ONLINE MAPPING  
 © AgriData, Inc. 2021 www.AgriDataInc.com



Area Symbol: IA143, Soil Area Version: 32							
Code	Soil Description	Acres	Percent of field	CSR2 Legend	Non-Irr Class *c	CSR2**	CSR
310B	Galva silty clay loam, 2 to 5 percent slopes	73.13	48.3%		Ile	95	81
311	Galva silty clay loam, stratified substratum, 0 to 2 percent slopes	41.84	27.6%		I	100	86
735	Havelock loam, 0 to 2 percent slopes, occasionally flooded	29.41	19.4%		Ilw	74	57
108B2	Wadena loam, 24 to 32 inches to sand and gravel, 2 to 5 percent slopes, moderately eroded	2.45	1.6%		Ile	52	38
32	Spicer silty clay loam, 0 to 2 percent slopes	2.20	1.5%		Ilw	94	76
203	Cylinder loam, 0 to 2 percent slopes	1.31	0.9%		Ils	58	49
577C2	Everly clay loam, 5 to 9 percent slopes, moderately eroded	0.68	0.4%		Illle	81	63
91B	Primghar silty clay loam, 2 to 5 percent slopes	0.38	0.3%		Ile	95	81
5010	Pits, sand and gravel	0.16	0.1%			0	0
Weighted Average					1.73	91.1	76.5

\*\*IA has updated the CSR values for each county to CSR2.

\*c: Using Capabilities Class Dominant Condition Aggregation Method  
 Soils data provided by USDA and NRCS.