

# Aerial Map



**Midwest Land**  
712-262-3110 MANAGEMENT

Maps provided by:



©AgriData, Inc. 2012

[www.AgriDataInc.com](http://www.AgriDataInc.com)

**29-97N-38W**  
**Clay County**  
**Iowa**

map center: 43° 11' 27.91, 95° 21' 29.76

scale: 8794



9/13/2012

Field borders provided by Farm Service Agency as of 5/21/2008. Aerial photography provided by Aerial Photography Field Office.



# Soils Map-CSR(as of 1/21/12)

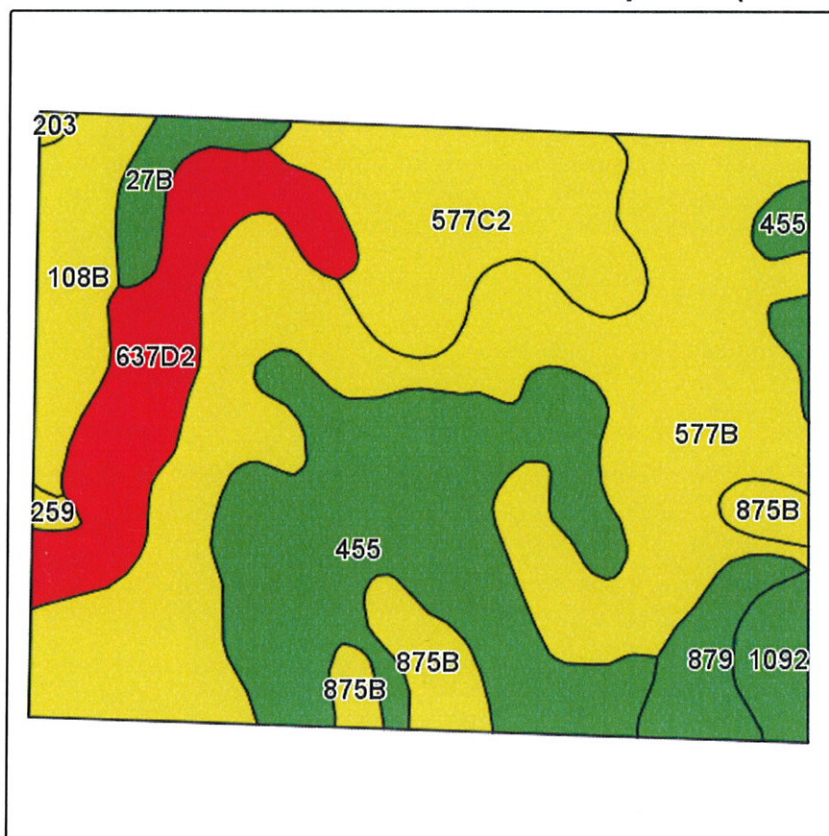

Field borders provided by Farm Service Agency as of 5/21/2008.  
Soils data provided by USDA and NRCS.

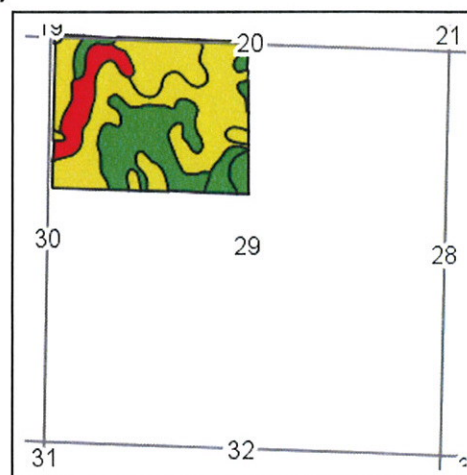

State: **Iowa**  
County: **Clay**  
Location: **29-97N-38W**  
Township: **Waterford**  
Acres: **118.2**  
Date: **10/1/2012**

**MIDWEST LAND** & REAL ESTATE, INC  
712-262-3110 MANAGEMENT



Maps provided by:



©AgriData, Inc 2012  
www.AgriDataInc.com

Code	Soil Description	Acres	Percent of field	CSR Legend	Non-Irr Class	CSR*	Corn	Soybeans
577B	Everly clay loam, 2 to 5 percent slopes	44.6	37.6%		Ile	68	177	41
455	Wilmonton clay loam, 1 to 3 percent slopes	27.3	23.1%		I	74	185	41
577C2	Everly clay loam, 5 to 9 percent slopes, moderately eroded	13.9	11.8%		IIle	51	154	37
637D2	Everly-Moneta complex, 9 to 14 percent slopes, moderately eroded	11.7	9.9%		IIIle	37	135	31
108B	Wadena loam, 24 to 32 inches to sand and gravel, 2 to 5 percent slopes	6.6	5.5%		Ile	47	148	29
875B	Roine fine sandy loam, 2 to 5 percent slopes	4.8	4.1%		IIIle	41	140	37
879	Fostoria loam, 1 to 3 percent slopes	3.6	3.1%		I	72	182	41
27B	Terril loam, 2 to 5 percent slopes	2.6	2.2%		Ile	75	186	43
1092	Gillett Grove silty clay loam, 0 to 2 percent slopes	2.5	2.1%		IIw	78	190	53
259	Biscay clay loam, 32 to 40 inches to sand and gravel, 0 to 2 percent slopes	0.4	0.3%		IIw	70	180	38
203	Cylinder loam, 32 to 40 inches to sand and gravel, 0 to 2 percent slopes	0.2	0.2%		IIIs	71	181	40
Weighted Average						62.5	169.3	39

Note: ALL soils information on this page is dated 1/21/2012

\*CSR ratings will be available for a limited time to aid in the transition to CSR2.



# Soils Map-CSR2

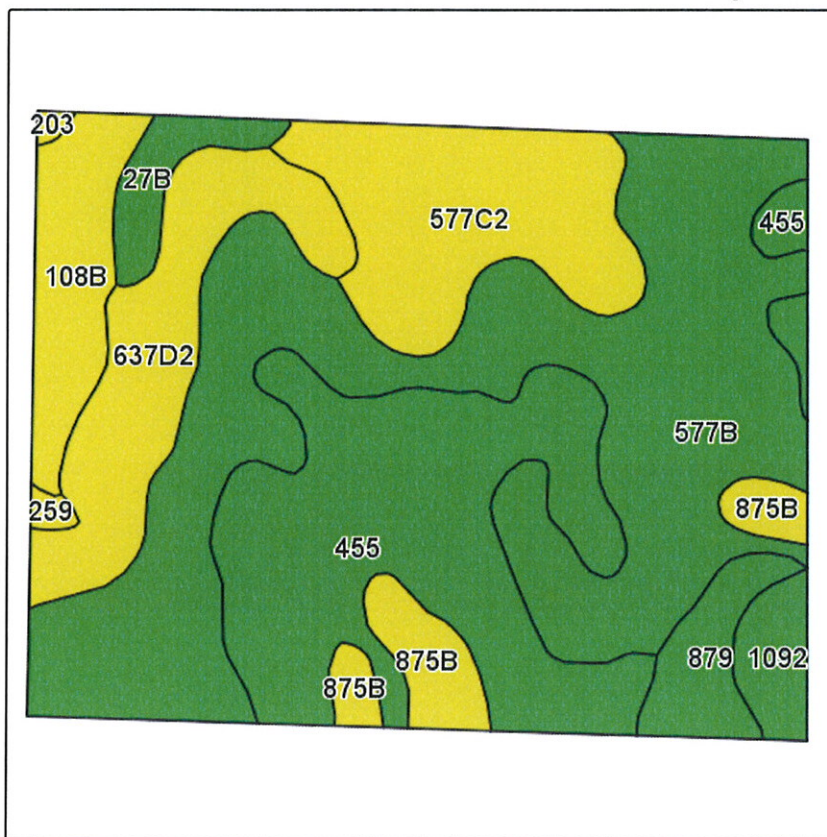

Field borders provided by Farm Service Agency as of 5/21/2008.  
Soils data provided by USDA and NRCS.

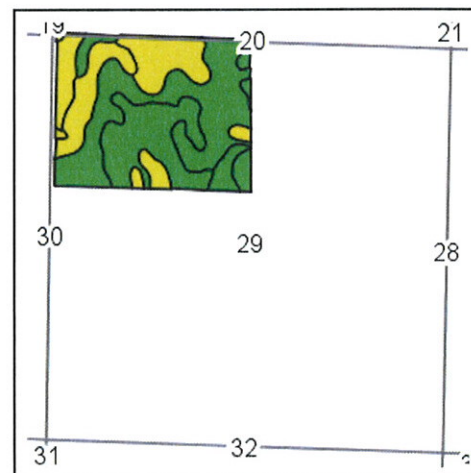

State: **Iowa**  
County: **Clay**  
Location: **29-97N-38W**  
Township: **Waterford**  
Acres: **118.2**  
Date: **10/1/2012**

**MIDWEST LAND** & REAL ESTATE, INC  
712-262-3110 MANAGEMENT



Maps provided by:



©AgriData, Inc 2012  
www.AgriDataInc.com

Code	Soil Description	Acres	Percent of field	CSR Legend	Non-Irr Class	CSR2**
577B	Everly clay loam, 2 to 5 percent slopes	44.6	37.6%		Ile	74
455	Wilmonton clay loam, 1 to 3 percent slopes	27.3	23.1%		I	77
577C2	Everly clay loam, 5 to 9 percent slopes, moderately eroded	13.9	11.8%		IIle	69
637D2	Everly-Moneta complex, 9 to 14 percent slopes, moderately eroded	11.7	9.9%		IIle	42
108B	Wadena loam, 24 to 32 inches to sand and gravel, 2 to 5 percent slopes	6.6	5.5%		Ile	42
875B	Roine fine sandy loam, 2 to 5 percent slopes	4.8	4.1%		IIle	67
879	Fostoria loam, 1 to 3 percent slopes	3.6	3.1%		I	77
27B	Terril loam, 2 to 5 percent slopes	2.6	2.2%		Ile	76
1092	Gillett Grove silty clay loam, 0 to 2 percent slopes	2.5	2.1%		IIw	84
259	Biscay clay loam, 32 to 40 inches to sand and gravel, 0 to 2 percent slopes	0.4	0.3%		IIw	43
203	Cylinder loam, 32 to 40 inches to sand and gravel, 0 to 2 percent slopes	0.2	0.2%		IIls	49
Weighted Average						69

\*\*These values could be either CSR or CSR2 until updates are completed by October 1, 2012. To confirm value status, run a CSR map and compare values. If they are identical to the CSR2 map, the map reflects CSR values, if they are different, the map reflects CSR2 values

## Soils Map-CSR(as of 1/21/12)

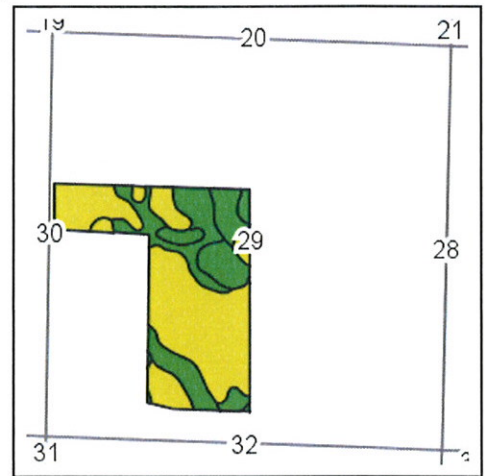
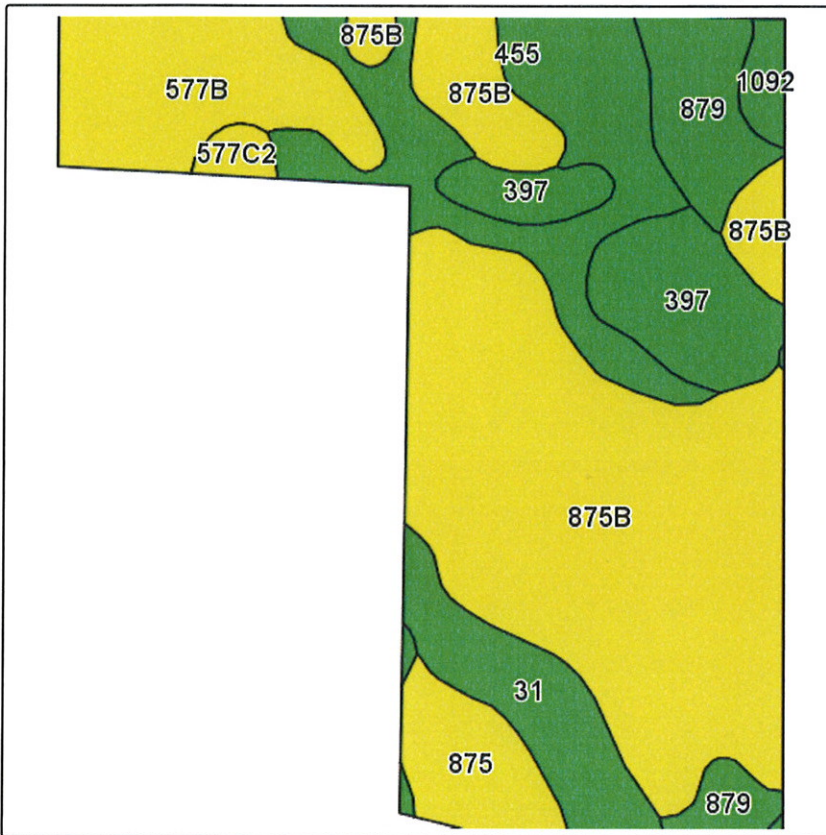

State: **Iowa**  
 County: **Clay**  
 Location: **29-97N-38W**  
 Township: **Waterford**  
 Acres: **106.2**  
 Date: **10/1/2012**

& REAL ESTATE, INC  
**MIDWEST LAND**  
 712-262-3110 MANAGEMENT



Maps provided by:



©AgriData, Inc 2012  
 www.AgriDataInc.com

Field borders provided by Farm Service Agency as of 5/21/2008.  
 Soils data provided by USDA and NRCS.

Code	Soil Description	Acres	Percent of field	CSR Legend	Non-Irr Class	CSR*	Corn	Soybeans
875B	Roine fine sandy loam, 2 to 5 percent slopes	46.3	43.8%		IIIe	41	140	37
455	Wilmonton clay loam, 1 to 3 percent slopes	15.9	14.9%		I	74	185	41
577B	Everly clay loam, 2 to 5 percent slopes	12.1	11.4%		Ile	68	177	41
397	Letri clay loam, 0 to 2 percent slopes	9.2	8.6%		IIw	72	182	44
31	Afton silty clay loam, 0 to 2 percent slopes	7.8	7.3%		IIw	75	186	51
879	Fostoria loam, 1 to 3 percent slopes	7.2	6.8%		I	72	182	41
875	Roine fine sandy loam, 0 to 2 percent slopes	5.3	5.0%		IIIs	46	147	38
1092	Gillett Grove silty clay loam, 0 to 2 percent slopes	1.4	1.3%		IIw	78	190	53
577C2	Everly clay loam, 5 to 9 percent slopes, moderately eroded	1	1.0%		IIIe	51	154	37
Weighted Average						57.1	162	40.2

Note: ALL soils information on this page is dated 1/21/2012

\*CSR ratings will be available for a limited time to aid in the transition to CSR2.



# Soils Map-CSR2

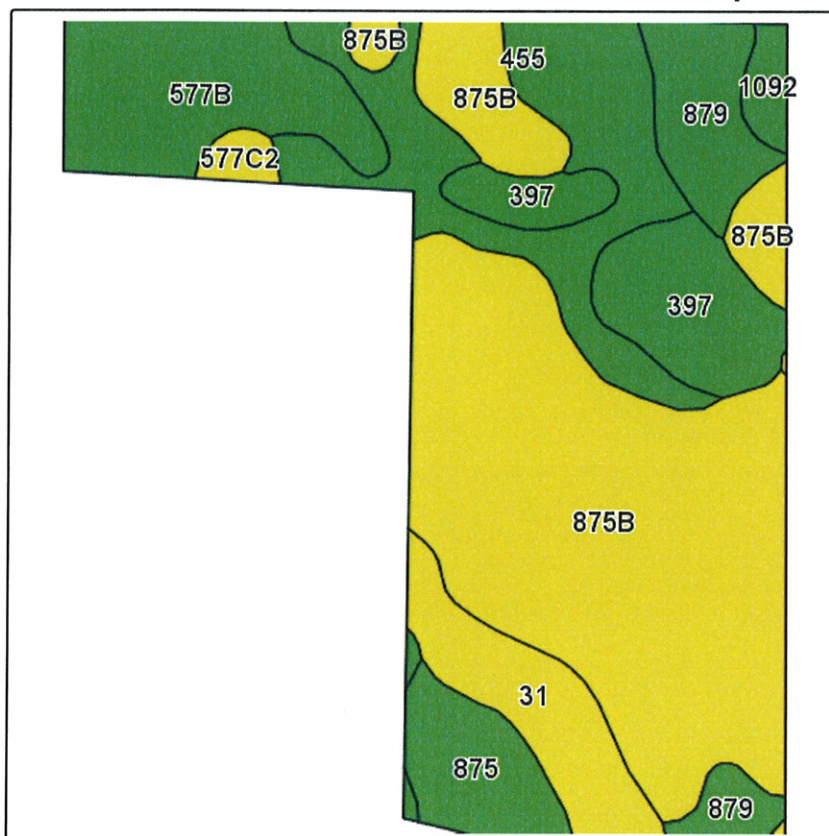

Field borders provided by Farm Service Agency as of 5/21/2008.  
Soils data provided by USDA and NRCS.

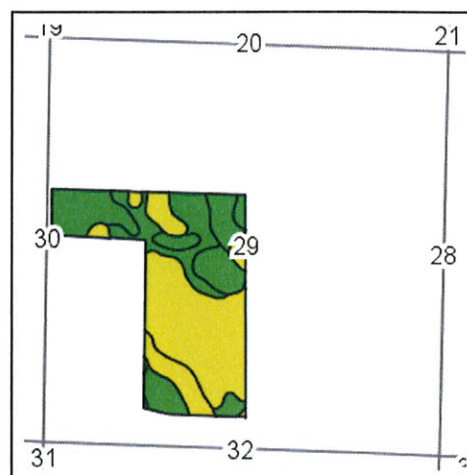

State: **Iowa**  
County: **Clay**  
Location: **29-97N-38W**  
Township: **Waterford**  
Acres: **106.2**  
Date: **10/1/2012**

**MIDWEST LAND** & REAL ESTATE, INC  
712-262-3110 MANAGEMENT



Maps provided by:



Code	Soil Description	Acres	Percent of field	CSR Legend	Non-Irr Class	CSR2**
875B	Roine fine sandy loam, 2 to 5 percent slopes	46.3	43.8%		IIIe	67
455	Wilmington clay loam, 1 to 3 percent slopes	15.9	14.9%		I	77
577B	Everly clay loam, 2 to 5 percent slopes	12.1	11.4%		Ile	74
397	Letri clay loam, 0 to 2 percent slopes	9.2	8.6%		IIw	76
31	Afton silty clay loam, 0 to 2 percent slopes	7.8	7.3%		IIw	71
879	Fostoria loam, 1 to 3 percent slopes	7.2	6.8%		I	77
875	Roine fine sandy loam, 0 to 2 percent slopes	5.3	5.0%		IIIs	72
1092	Gillett Grove silty clay loam, 0 to 2 percent slopes	1.4	1.3%		IIw	84
577C2	Everly clay loam, 5 to 9 percent slopes, moderately eroded	1	1.0%		IIIe	69
Weighted Average						71.6

\*\*These values could be either CSR or CSR2 until updates are completed by October 1, 2012. To confirm value status, run a CSR map and compare values. If they are identical to the CSR2 map, the map reflects CSR values, if they are different, the map reflects CSR2 values