

Aerial Map

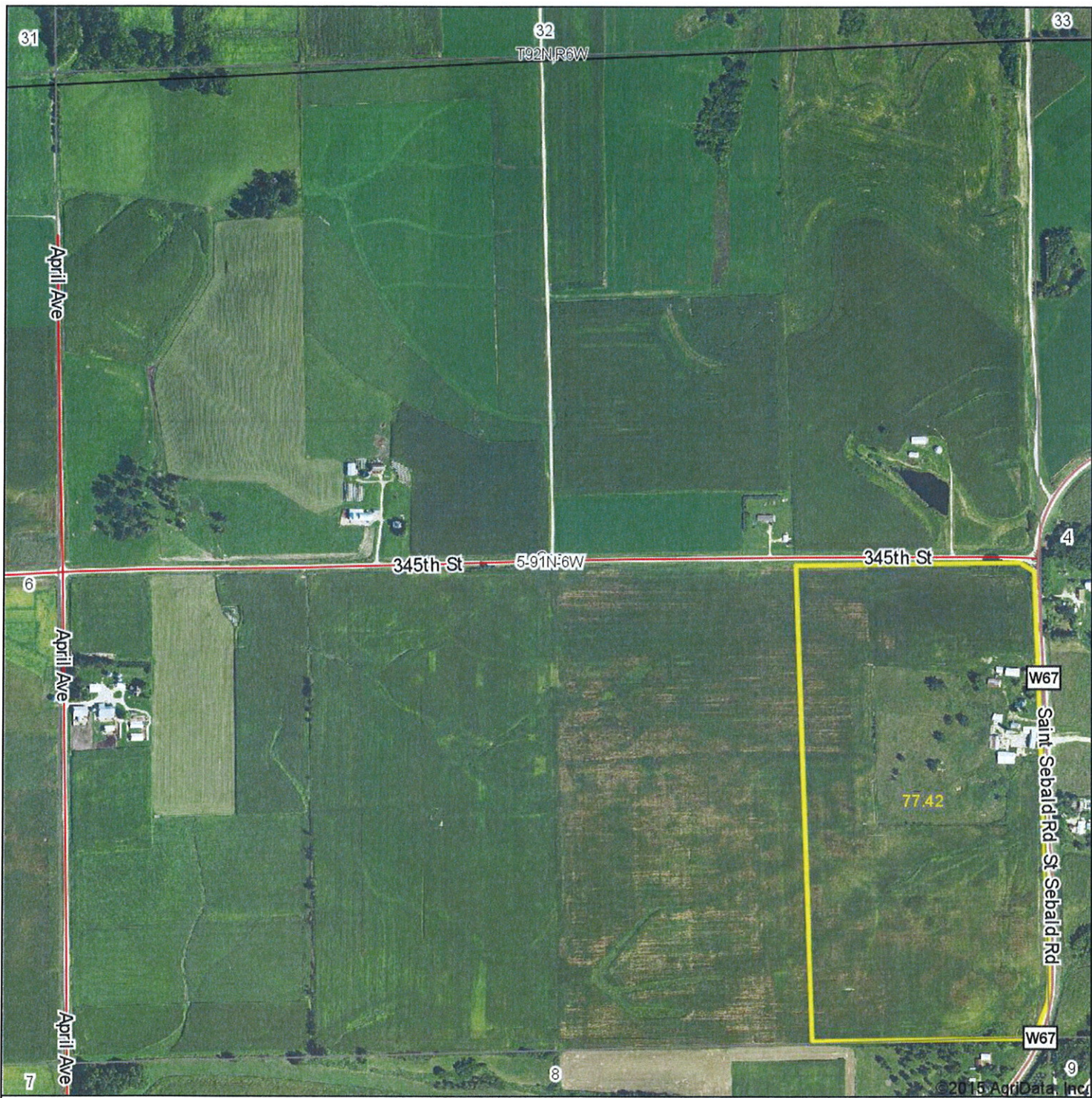

& REAL ESTATE, INC
MIDWEST LAND
712-262-3110 MANAGEMENT

Maps Provided By:

 **surety**
CUSTOMIZED ONLINE MAPPING
© AgriData, Inc. 2015 www.AgrDataInc.com

5-91N-6W
Clayton County
Iowa

map center: 42° 43' 28.84, 91° 34' 34.83

scale: 9758



9/28/2015

Soils Map-CSR2

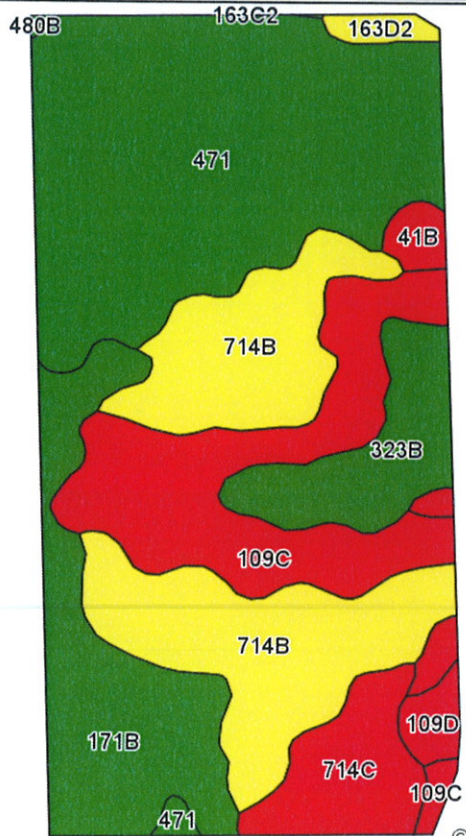

Soils data provided by USDA and NRCS.

©2015 AgriData, Inc.

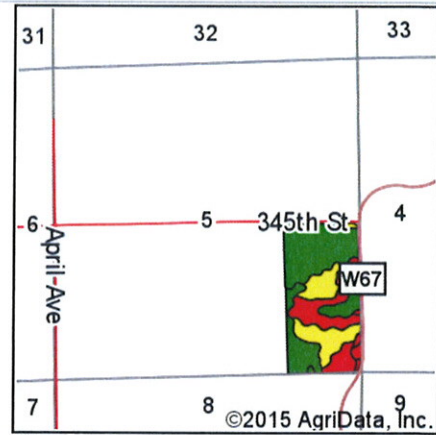

State: Iowa
County: Clayton
Location: 5-91N-6W
Township: Cass
Acres: 77.42
Date: 9/28/2015







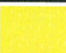

& REAL ESTATE, INC.
MIDWEST LAND
712-262-3110 MANAGEMENT

Maps Provided By:

 **surety**
CUSTOMIZED ONLINE MAPPING
© AgriData, Inc. 2015 www.AgriDataInc.com

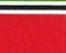

Area Symbol: IA043, Soil Area Version: 18

Code	Soil Description	Acres	Percent of field	CSR2 Legend	Non-Irr Class *c	Irr Class *c	CSR2**	CSR	Corn	Soybeans
471	Oran loam, 0 to 2 percent slopes	25.06	32.4%		Iw		86	85		
714B	Winneshiek loam, 20 to 30 inches to limestone, 2 to 5 percent slopes	17.04	22.0%		Ile		42	53		
109C	Backbone fine sandy loam, 5 to 9 percent slopes	12.80	16.5%		IVs		32	15		
171B	Bassett loam, 2 to 5 percent slopes	10.17	13.1%		Ile		85	80	215	62
323B	Terril loam, sandy substratum, 2 to 5 percent slopes	5.21	6.7%		Ile		80	72		
714C	Winneshiek loam, 20 to 30 inches to limestone, 5 to 9 percent slopes	4.38	5.7%		IIIe		37	33		
109D	Backbone fine sandy loam, 9 to 14 percent slopes	1.24	1.6%		Vis		5	5		
41B	Sparta loamy fine sand, 2 to 5 percent slopes	0.83	1.1%		IVs	Ile	38	40		
163D2	Fayette silt loam, 9 to 14 percent slopes, moderately eroded	0.69	0.9%		IIIe		48	58		
Weighted Average							61.9	59.9	28.2	8.1

**IA has updated the CSR values for each county to CSR2.

*c: Using Capabilities Class Dominant Condition Aggregation Method

Soils data provided by USDA and NRCS.