

# Aerial Map



& REAL ESTATE, INC.  
**MIDWEST LAND**  
712-262-3110 MANAGEMENT

Maps provided by:



©AgriData, Inc. 2012  
www.AgrIDataInc.com

**6-97N-34W**  
**Palo Alto County**  
**Iowa**

map center: 43° 14' 53.16, 94° 54' 18.17  
scale: 8436



6/28/2013

Field borders provided by Farm Service Agency as of 5/21/2008. Aerial photography provided by Aerial Photography Field Office.



# Soils Map-CSR(as of 1/21/12)

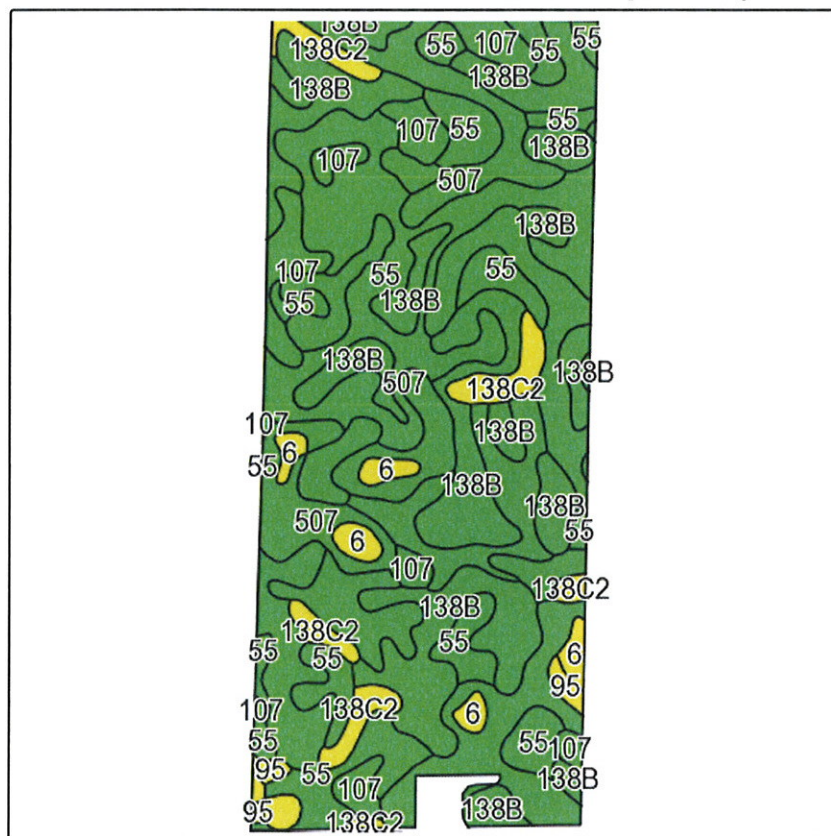

Field borders provided by Farm Service Agency as of 5/21/2008.  
Soils data provided by USDA and NRCS.

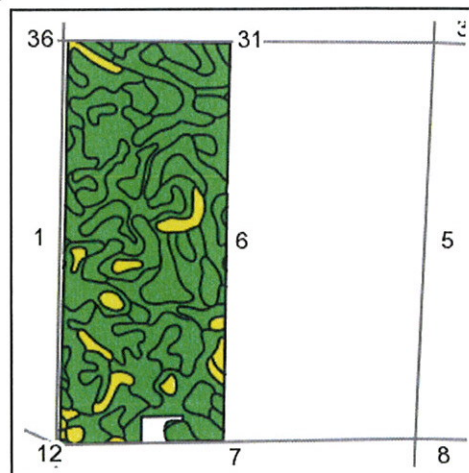

State: **Iowa**  
County: **Palo Alto**  
Location: **6-97N-34W**  
Township: **Lost Island**  
Acres: **233.6**  
Date: **6/28/2013**

**MIDWEST LAND** & REAL ESTATE, INC  
712-262-3110 MANAGEMENT



Maps provided by:



Code	Soil Description	Acres	Percent of field	CSR Legend	Non-Irr Class	CSR*	Corn	Soybeans
55	Nicollet loam, 1 to 3 percent slopes	80.9	34.7%		I	84	200	47
138B	Clarion loam, 2 to 5 percent slopes	70.3	30.1%		IIe	76	190	43
507	Canisteo silty clay loam, 0 to 2 percent slopes	45.4	19.4%		IIw	74	187	41
107	Webster silty clay loam, 0 to 2 percent slopes	19	8.1%		IIw	79	194	43
138C2	Clarion loam, 5 to 9 percent slopes, moderately eroded	10.9	4.6%		IIIe	58	165	40
6	Okoboji silty clay loam, 0 to 1 percent slopes	5.4	2.3%		IIIw	54	160	34
95	Harp loam, 0 to 2 percent slopes	1.7	0.7%		IIw	59	167	37
Weighted Average						77.1	191	43.6

Note: ALL soils information on this page is dated 1/21/2012

\*CSR ratings will be available for a limited time to aid in the transition to CSR2.