

# Soils Map-CSR2

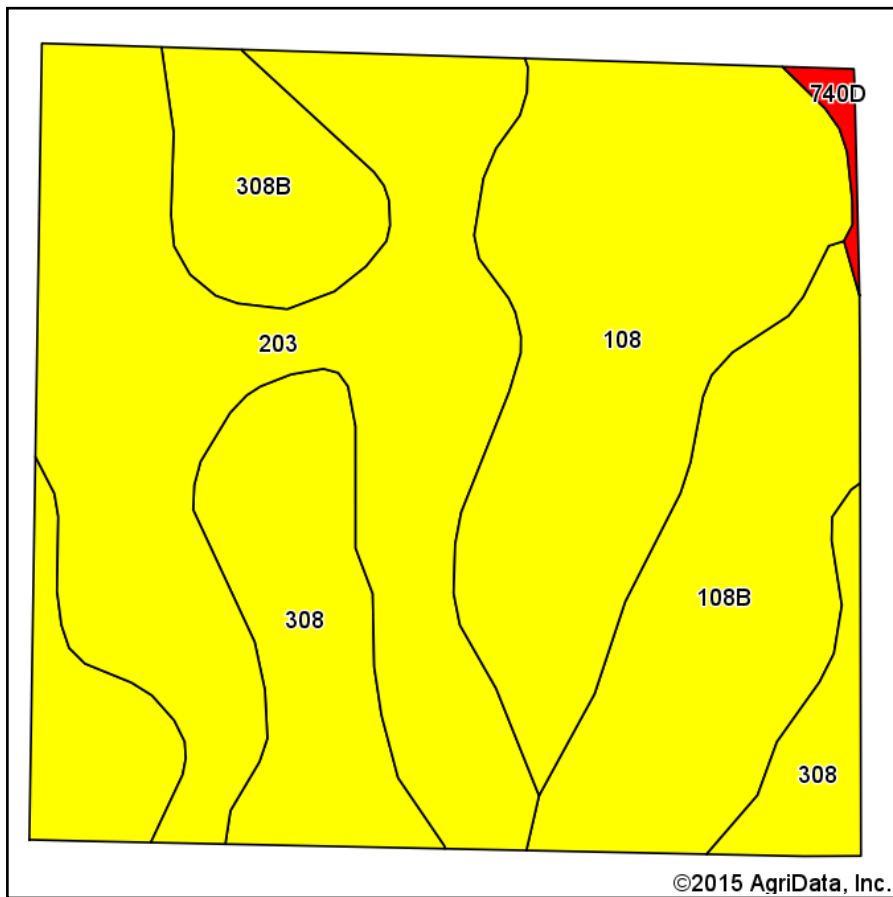

Soils data provided by USDA and NRCS.

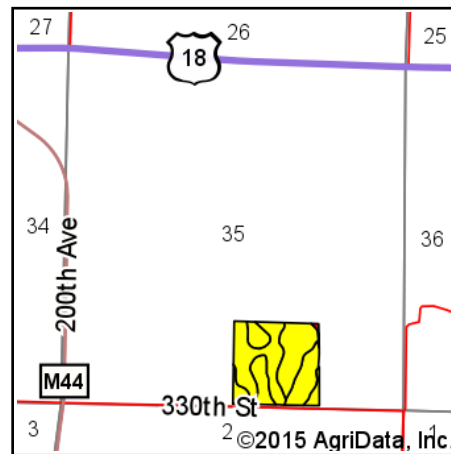

State: **Iowa**  
 County: **Clay**  
 Location: **35-97N-37W**  
 Township: **Summit**  
 Acres: **39.22**  
 Date: **10/6/2015**

& REAL ESTATE, INC.  
**MIDWEST LAND**  
 712-262-3110 MANAGEMENT

Maps Provided By:

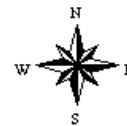

## Area Symbol: IA041, Soil Area Version: 22

Code	Soil Description	Acres	Percent of field	CSR2 Legend	Non-Irr Class *c	CSR2**	CSR
203	Cylinder loam, 32 to 40 inches to sand and gravel, 0 to 2 percent slopes	13.74	35.0%		Ils	59	71
108	Wadena loam, 24 to 32 inches to sand and gravel, 0 to 2 percent slopes	9.58	24.4%		Ils	55	52
308	Wadena loam, 32 to 40 inches to sand and gravel, 0 to 2 percent slopes	6.97	17.8%		Ils	60	65
108B	Wadena loam, 24 to 32 inches to sand and gravel, 2 to 5 percent slopes	6.17	15.7%		Ile	52	47
308B	Wadena loam, 32 to 40 inches to sand and gravel, 2 to 5 percent slopes	2.53	6.5%		Ile	55	60
740D	Hawick gravelly loamy sand, 9 to 14 percent slopes	0.23	0.6%		IVs	6	5
Weighted Average						56.5	60.4

Area Symbol: IA041, Soil Area Version: 22

\*\*IA has updated the CSR values for each county to CSR2.

\*c: Using Capabilities Class Dominant Condition Aggregation Method

Soils data provided by USDA and NRCS.