

Soils Map-CSR2

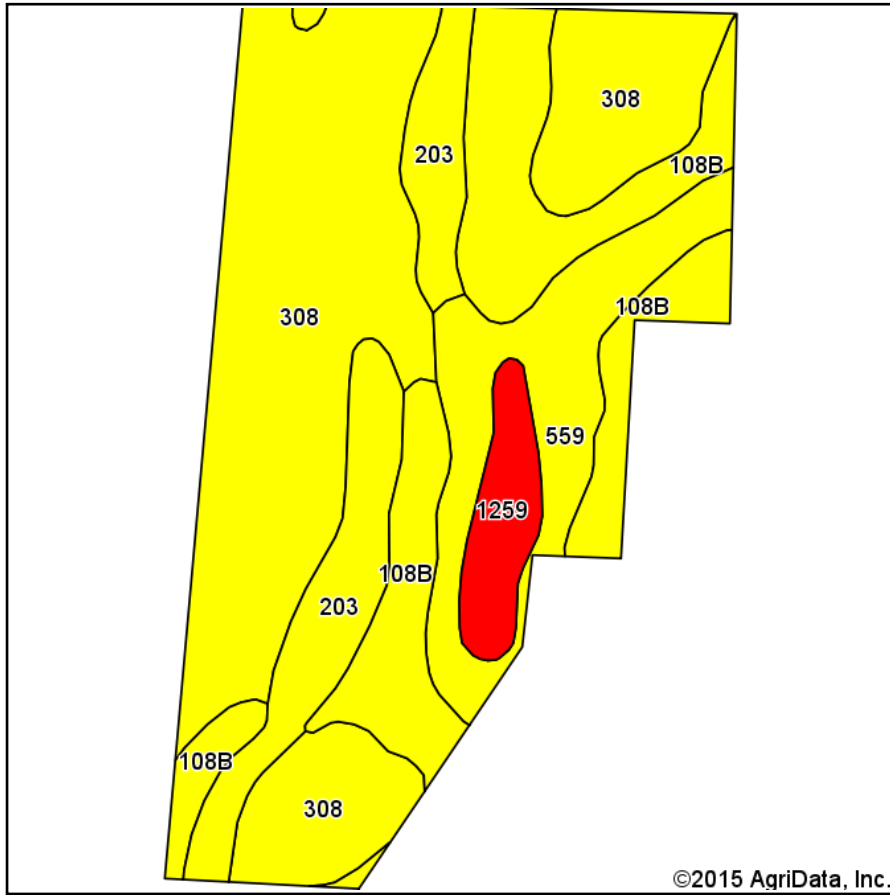

Soils data provided by USDA and NRCS.

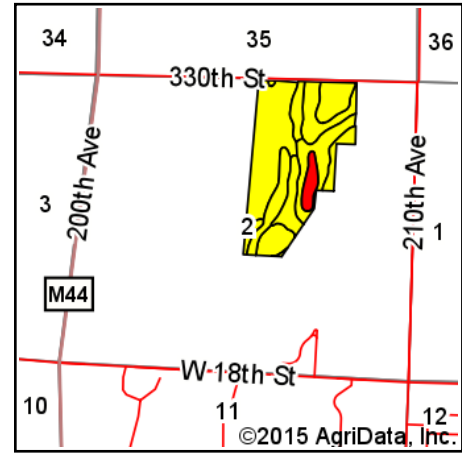

State: **Iowa**
 County: **Clay**
 Location: **2-96N-37W**
 Township: **Riverton**
 Acres: **87.69**
 Date: **10/6/2015**

& REAL ESTATE, INC.
Midwest Land
 712-262-3110 MANAGEMENT

Maps Provided By:



© AgriData, Inc. 2015 www.AgriDataInc.com



Area Symbol: IA041, Soil Area Version: 22

Code	Soil Description	Acres	Percent of field	CSR2 Legend	Non-Irr Class *c	CSR2**	CSR
308	Wadena loam, 32 to 40 inches to sand and gravel, 0 to 2 percent slopes	40.60	46.3%		Ils	60	65
108B	Wadena loam, 24 to 32 inches to sand and gravel, 2 to 5 percent slopes	20.50	23.4%		Ile	52	47
559	Talcot clay loam, 32 to 40 inches to sand and gravel, 0 to 2 percent slopes	11.60	13.2%		Ilw	52	65
203	Cylinder loam, 32 to 40 inches to sand and gravel, 0 to 2 percent slopes	11.13	12.7%		Ils	59	71
1259	Biscay clay loam, depressional, 0 to 1 percent slopes	3.86	4.4%		Illw	13	49
Weighted Average						54.9	60.8

Area Symbol: IA041, Soil Area Version: 22

*IA has updated the CSR values for each county to CSR2.

c: Using Capabilities Class Dominant Condition Aggregation Method

Soils data provided by USDA and NRCS.