

Soils Map

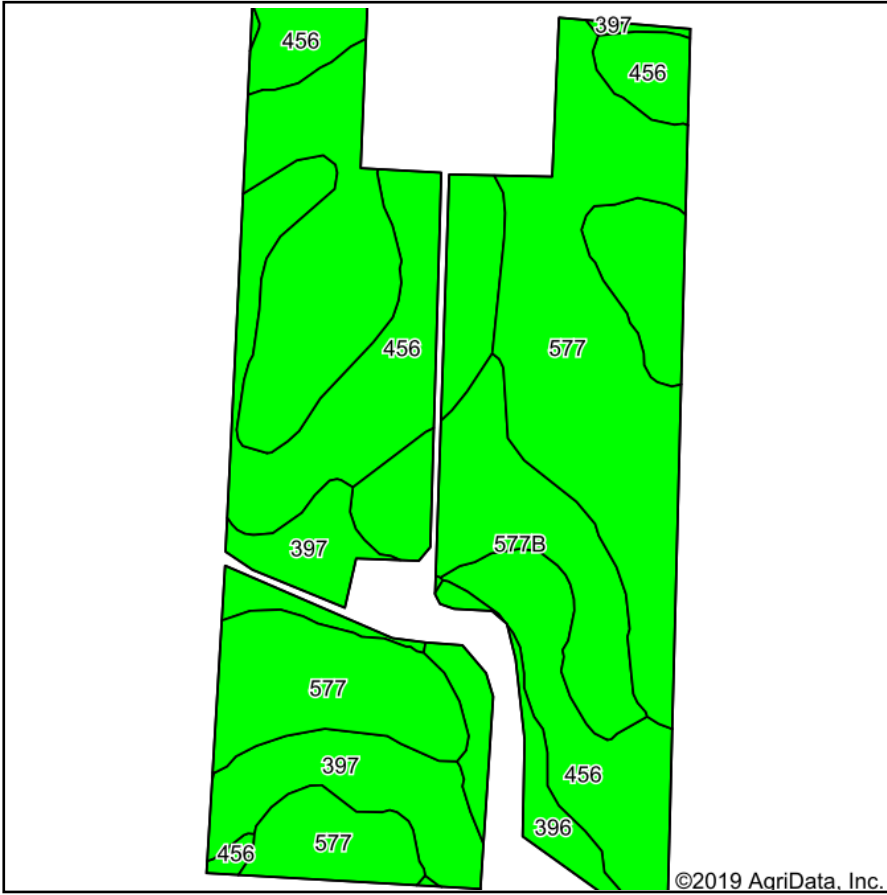

Soils data provided by USDA and NRCS.

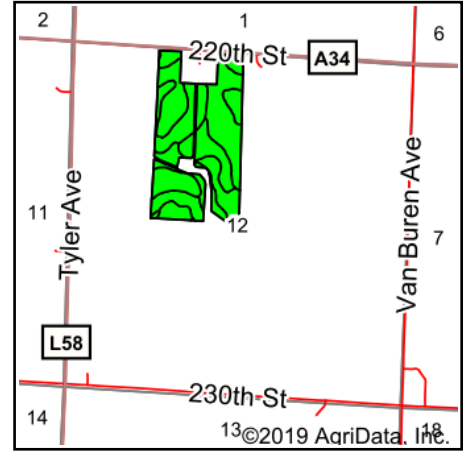

State: **Iowa**
 County: **Osceola**
 Location: **12-98N-40W**
 Township: **Baker**
 Acres: **68.04**
 Date: **2/4/2020**

& REAL ESTATE, INC
MIDWEST LAND
 712-262-3110 MANAGEMENT
 Maps Provided By:

 CUSTOMIZED ONLINE MAPPING
 © AgriData, Inc. 2019 www.AgriDataInc.com



Area Symbol: IA143. Soil Area Version: 30								
Code	Soil Description	Acres	Percent of field	CSR2 Legend	Non-Irr Class *c	CSR2**	CSR	
577	Everly clay loam, 0 to 2 percent slopes	29.61	43.5%		I	96	78	
456	Wilmington silty clay loam, 0 to 3 percent slopes	21.10	31.0%		Iw	91	78	
577B	Everly clay loam, 2 to 5 percent slopes	7.40	10.9%		Ile	90	72	
397	Letri silty clay loam, 0 to 2 percent slopes	7.32	10.8%		Ilw	90	72	
396	Letri silty clay loam, calcareous, 0 to 2 percent slopes	2.61	3.8%		Ilw	89	72	
Weighted Average						92.9	76.5	

**IA has updated the CSR values for each county to CSR2.
 *c: Using Capabilities Class Dominant Condition Aggregation Method
 Soils data provided by USDA and NRCS.