

Soils Map

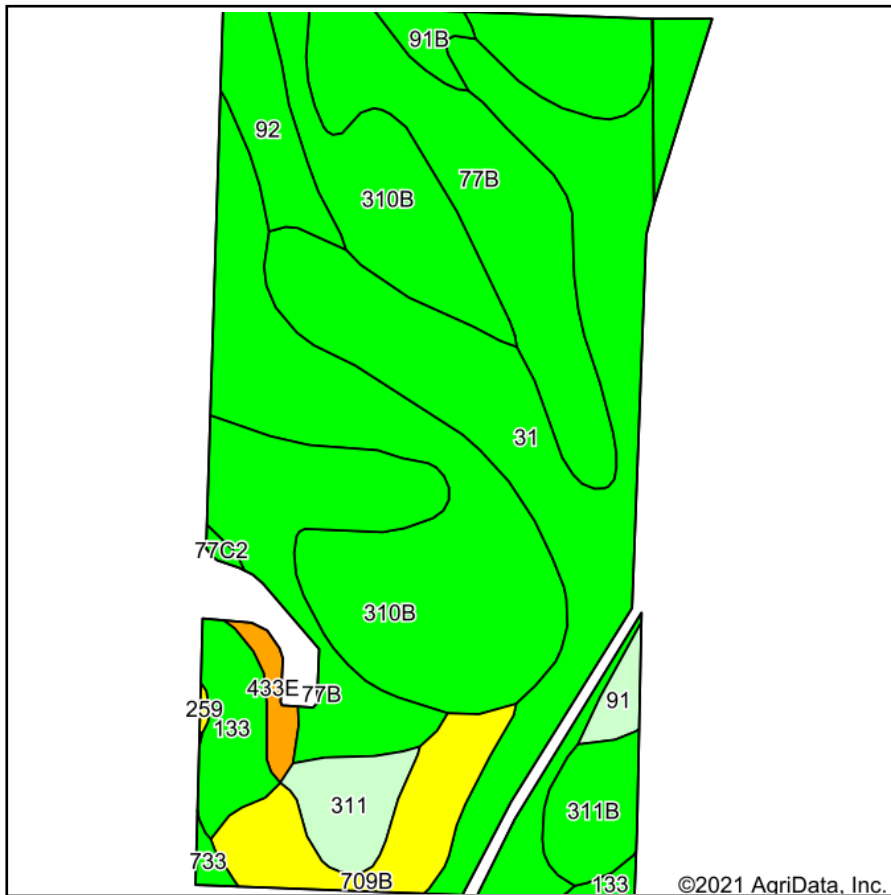

Soils data provided by USDA and NRCS.

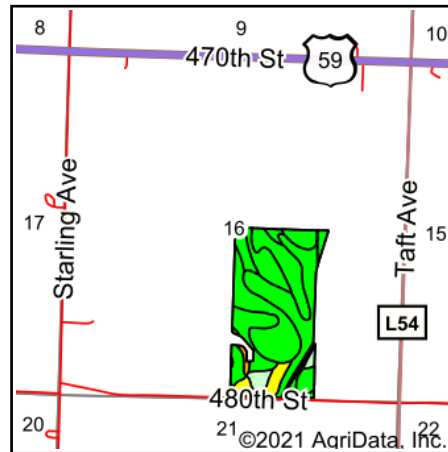

State: **Iowa**
 County: **Obrien**
 Location: **16-94N-40W**
 Township: **Liberty**
 Acres: **75.23**
 Date: **9/9/2021**

MIDWEST LAND & REAL ESTATE, INC
 MANAGEMENT
 712-262-3110

Maps Provided By:

 CUSTOMIZED ONLINE MAPPING
 © AgriData, Inc. 2021 www.AgriDataInc.com



Area Symbol: IA141, Soil Area Version: 25

Code	Soil Description	Acres	Percent of field	CSR2 Legend	Non-Irr Class *c	CSR2**	CSR
310B	Galva silty clay loam, 2 to 5 percent slopes	20.60	27.4%		Ile	95	70
31	Afton silty clay loam, 0 to 2 percent slopes, occasionally flooded	19.41	25.8%		Ilw	80	72
77B	Sac silty clay loam, loam substratum, 2 to 5 percent slopes	18.40	24.5%		Ile	95	68
709B	Fairhaven silt loam, 32 to 40 inches to sand and gravel, 2 to 5 percent slopes	4.25	5.6%		Ile	54	63
133	Colo silty clay loam, deep loess, 0 to 2 percent slopes, occasionally flooded	2.68	3.6%		Ilw	78	73
92	Marcus silty clay loam, 0 to 2 percent slopes	2.67	3.5%		Ilw	94	75
311B	Galva silty clay loam, stratified substratum, 2 to 5 percent slopes	2.29	3.0%		Ile	91	69
311	Galva silty clay loam, stratified substratum, 0 to 2 percent slopes	2.13	2.8%		I	100	74
91B	Primghar silty clay loam, 2 to 5 percent slopes	0.82	1.1%		Ile	95	78
433E	Storden loam, 14 to 18 percent slopes	0.78	1.0%		IVe	31	25
91	Primghar silty clay loam, 0 to 2 percent slopes	0.71	0.9%		Iw	100	80
733	Calco silty clay loam, 0 to 2 percent slopes, occasionally flooded	0.28	0.4%		Ilw	78	68
77C2	Sac silty clay loam, loam substratum, 5 to 9 percent slopes, eroded	0.14	0.2%		IIIe	88	51
259	Biscay clay loam, 32 to 40 inches to sand and gravel, 0 to 2 percent slopes	0.07	0.1%		Ilw	54	67
Weighted Average						87.5	69.7

**IA has updated the CSR values for each county to CSR2.
 *c: Using Capabilities Class Dominant Condition Aggregation Method
 Soils data provided by USDA and NRCS.