

# Soils Map

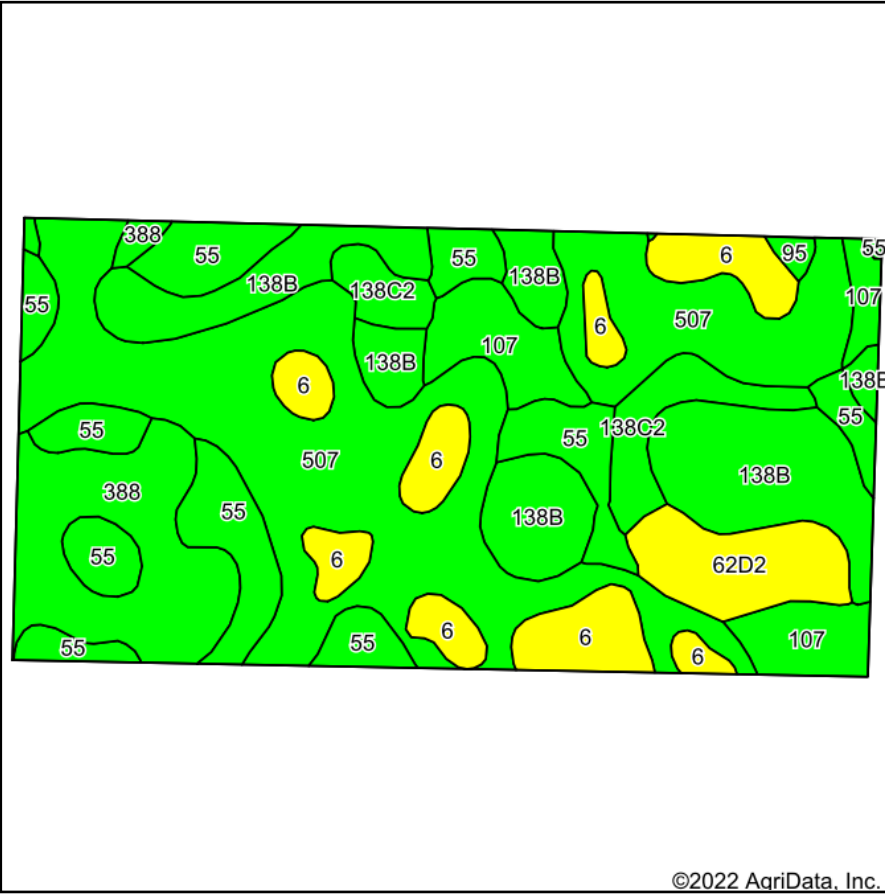

Soils data provided by USDA and NRCS.

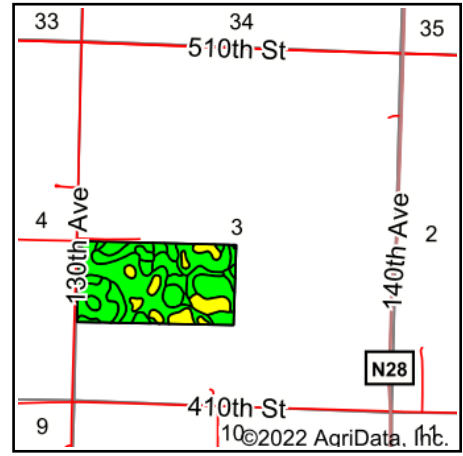

State: **Iowa**  
 County: **Pocahontas**  
 Location: **3-93N-34W**  
 Township: **Swan Lake**  
 Acres: **78.26**  
 Date: **12/12/2022**

**MIDWEST LAND** & REAL ESTATE, INC  
 712-262-3110 MANAGEMENT  
 Maps Provided By: **surety**  
 CUSTOMIZED ONLINE MAPPING  
 © AgriData, Inc. 2021 www.AgriDataInc.com

Area Symbol: IA151, Soil Area Version: 29

Code	Soil Description	Acres	Percent of field	CSR2 Legend	CSR2**	CSR
507	Canisteo clay loam, 0 to 2 percent slopes	25.85	33.0%		84	76
138B	Clarion loam, 2 to 6 percent slopes	13.37	17.1%		89	78
55	Nicollet clay loam, 1 to 3 percent slopes	11.57	14.8%		89	86
388	Kossuth silty clay loam, 0 to 2 percent slopes	7.65	9.8%		86	75
6	Okoboji silty clay loam, 0 to 1 percent slopes	7.51	9.6%		59	55
107	Webster clay loam, 0 to 2 percent slopes	5.03	6.4%		86	81
62D2	Storden loam, 10 to 16 percent slopes, moderately eroded	3.59	4.6%		41	40
138C2	Clarion loam, 6 to 10 percent slopes, moderately eroded	3.41	4.4%		83	62
95	Harps clay loam, 0 to 2 percent slopes	0.28	0.4%		72	60
<b>Weighted Average</b>					<b>81.5</b>	<b>73.7</b>

\*\*IA has updated the CSR values for each county to CSR2.  
 Soils data provided by USDA and NRCS.