

## Soils Map-CSR2

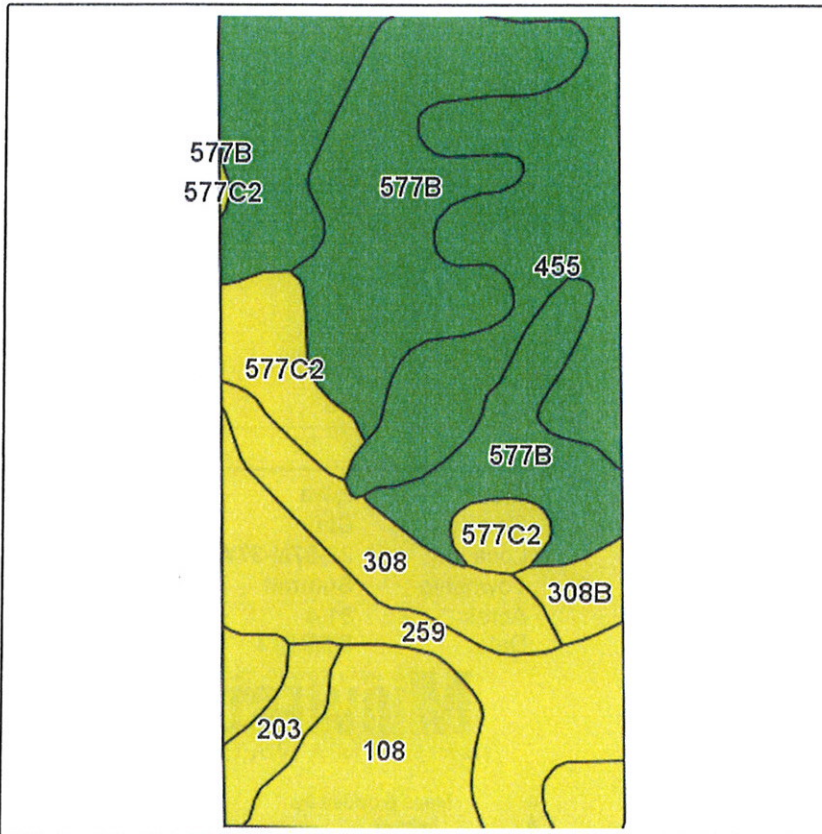

Field borders provided by Farm Service Agency as of 5/21/2008.  
Soils data provided by USDA and NRCS.

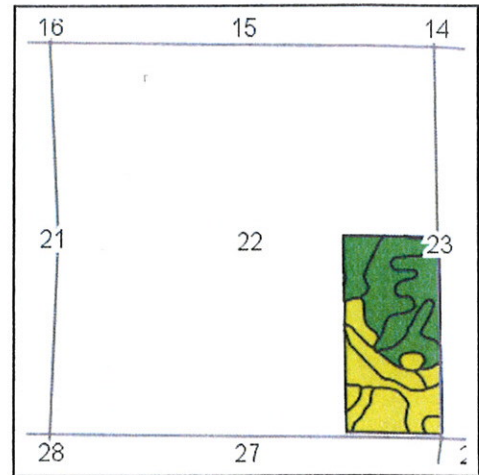

State: **Iowa**  
County: **Clay**  
Location: **22-97N-37W**  
Township: **Summit**  
Acres: **81.4**  
Date: **10/9/2012**

**MIDWEST LAND**  
712-262-3110 MANAGEMENT



Maps provided by:



Code	Soil Description	Acres	Percent of field	CSR Legend	Non-Irr Class	CSR2**
455	Wilmington clay loam, 1 to 3 percent slopes	22.3	27.3%		I	77
577B	Everly clay loam, 2 to 5 percent slopes	22.1	27.1%		Ile	74
259	Biscay clay loam, 32 to 40 inches to sand and gravel, 0 to 2 percent slopes	11.1	13.7%		Ilw	43
108	Wadena loam, 24 to 32 inches to sand and gravel, 0 to 2 percent slopes	10.5	12.9%		Ils	45
308	Wadena loam, 32 to 40 inches to sand and gravel, 0 to 2 percent slopes	6.1	7.5%		Ils	50
577C2	Everly clay loam, 5 to 9 percent slopes, moderately eroded	5.4	6.6%		Ille	69
203	Cylinder loam, 32 to 40 inches to sand and gravel, 0 to 2 percent slopes	2.3	2.9%		Ils	49
308B	Wadena loam, 32 to 40 inches to sand and gravel, 2 to 5 percent slopes	1.6	2.0%		Ile	45
Weighted Average						63.4

\*\*These values could be either CSR or CSR2 until updates are completed by October 1, 2012. To confirm value status, run a CSR map and compare values. If they are identical to the CSR2 map, the map reflects CSR values, if they are different, the map reflects CSR2 values

# Soils Map

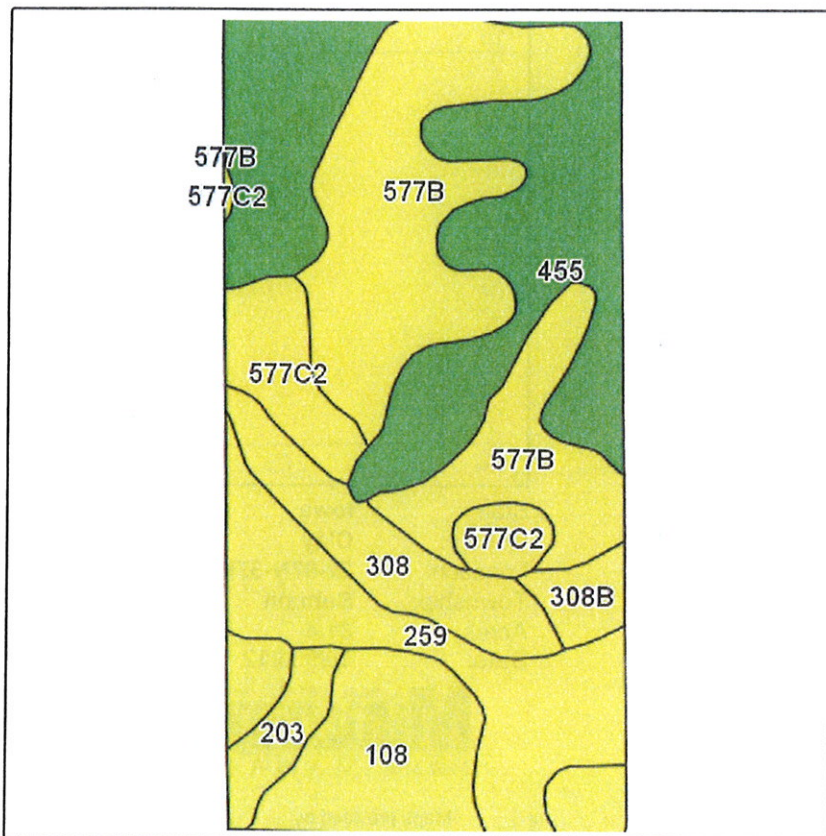

Field borders provided by Farm Service Agency as of 5/21/2008.  
Soils data provided by USDA and NRCS.

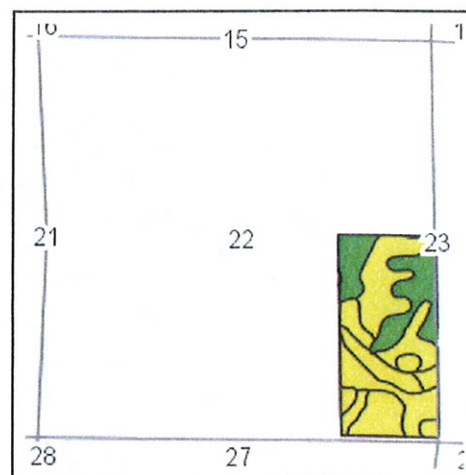

State: Iowa  
County: Clay  
Location: 22-97N-37W  
Township: Summit  
Acres: 81.4  
Date: 5/9/2012

& REAL ESTATE, INC  
**MIDWEST LAND**  
712-262-3110 MANAGEMENT



Maps provided by:



©AgriData, Inc 2012  
www.AgriDataInc.com

Code	Soil Description	Acres	Percent of field	CSR Legend	Non-Irr Class	CSR	Corn	Soybeans
455	Wilmington clay loam, 1 to 3 percent slopes	22.3	27.3%		I	74	185	41
577B	Everly clay loam, 2 to 5 percent slopes	22.1	27.1%		Ile	68	177	41
259	Biscay clay loam, 32 to 40 inches to sand and gravel, 0 to 2 percent slopes	11.1	13.7%		Ilw	70	180	38
108	Wadena loam, 24 to 32 inches to sand and gravel, 0 to 2 percent slopes	10.5	12.9%		Ilis	52	155	30
308	Wadena loam, 32 to 40 inches to sand and gravel, 0 to 2 percent slopes	6.1	7.5%		Ilis	65	173	35
577C2	Everly clay loam, 5 to 9 percent slopes, moderately eroded	5.4	6.6%		Ille	51	154	37
203	Cylinder loam, 32 to 40 inches to sand and gravel, 0 to 2 percent slopes	2.3	2.9%		Ilis	71	181	40
308B	Wadena loam, 32 to 40 inches to sand and gravel, 2 to 5 percent slopes	1.6	2.0%		Ile	60	166	33
Weighted Average						66.4	174.8	38.3