

# Soils Map

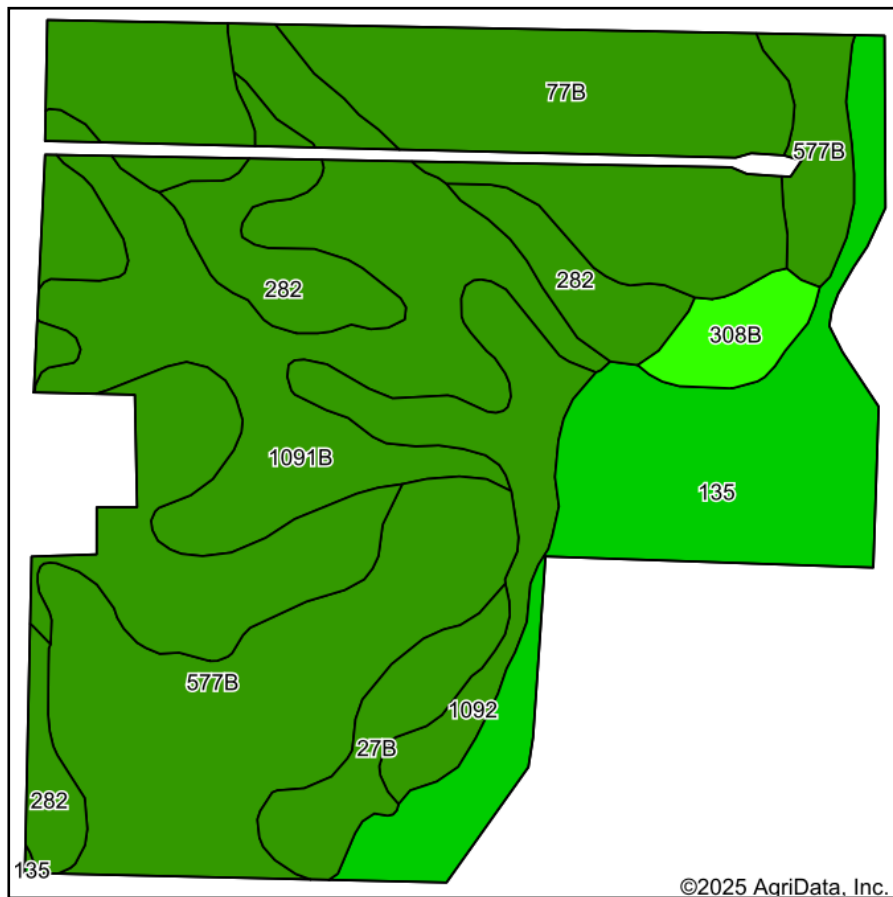

Soils data provided by USDA and NRCS.

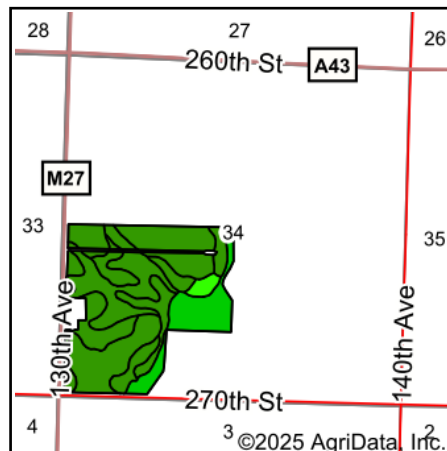

State: **Iowa**  
 County: **Dickinson**  
 Location: **34-98N-38W**  
 Township: **Westport**  
 Acres: **121.56**  
 Date: **7/29/2025**

**MIDWEST LAND** & REAL ESTATE, INC.  
 712-262-3110 MANAGEMENT  
 Maps Provided By:  
**surety**  
 CUSTOMIZED ONLINE MAPPING  
 © AgriData, Inc. 2023 www.AgriDataInc.com



Area Symbol: IA059, Soil Area Version: 34

Code	Soil Description	Acres	Percent of field	CSR2 Legend	Non-Irr Class *c	CSR2**	CSR
77B	Sac silty clay loam, loam substratum, 2 to 5 percent slopes	34.20	28.1%		Ile	95	76
1091B	McCreath silty clay loam, 2 to 5 percent slopes	22.69	18.7%		Iw	95	77
577B	Everly clay loam, 2 to 5 percent slopes	22.20	18.3%		Ile	91	73
135	Coland clay loam, 0 to 2 percent slopes, occasionally flooded	18.72	15.4%		Ilw	76	58
282	Ransom silty clay loam, 1 to 3 percent slopes	9.40	7.7%		Iw	95	78
1092	Gillett Grove silty clay loam, 0 to 2 percent slopes	7.31	6.0%		Ilw	94	79
27B	Terril loam, 2 to 6 percent slopes	4.39	3.6%		Ile	87	71
308B	Wadena loam, 2 to 6 percent slopes	2.65	2.2%		Ile	52	36
Weighted Average					1.74	90.1	72.1

\*\*IA has updated the CSR values for each county to CSR2.

\*c: Using Capabilities Class Dominant Condition Aggregation Method

Soils data provided by USDA and NRCS.