

Soils Map

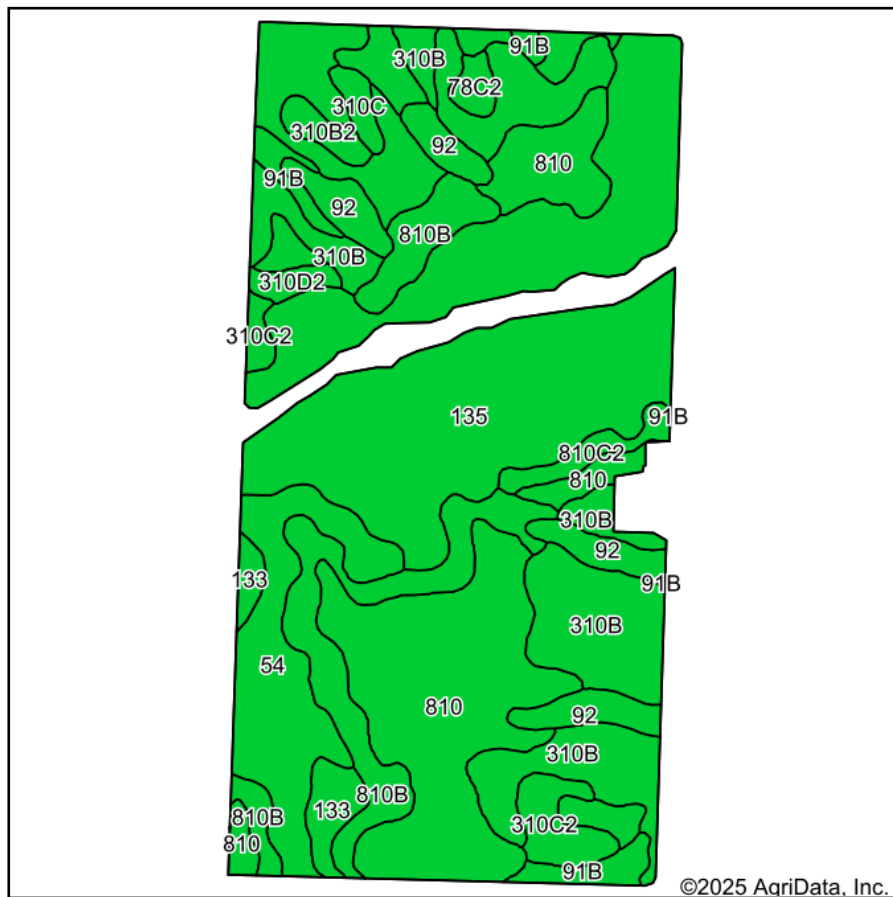

Soils data provided by USDA and NRCS.

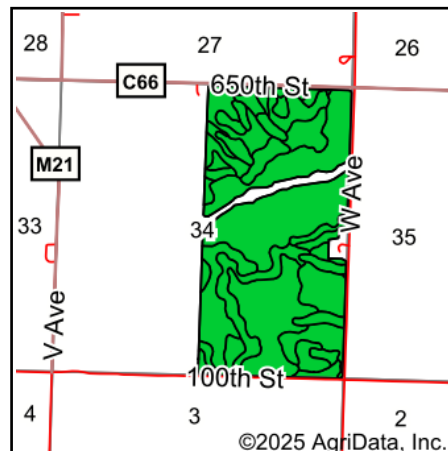

State: **Iowa**
 County: **Cherokee**
 Location: **34-90N-39W**
 Township: **Diamond**
 Acres: **298.19**
 Date: **10/17/2025**

& REAL ESTATE, INC
MIDWEST LAND
 712-262-3110 MANAGEMENT
 Maps Provided By:

 CUSTOMIZED ONLINE MAPPING
 © AgriData, Inc. 2023 www.AgriDataInc.com

Area Symbol: IA035, Soil Area Version: 34

Code	Soil Description	Acres	Percent of field	CSR2 Legend	Non-Irr Class *c	CSR2**	CSR
135	Coland clay loam, 0 to 2 percent slopes	86.48	28.9%		IIw	74	74
810	Galva silty clay loam, terrace, 0 to 2 percent slopes	54.34	18.2%		I	100	76
310B	Galva silty clay loam, 2 to 5 percent slopes	49.73	16.7%		Ile	95	71
810B	Galva silty clay loam, terrace, 2 to 5 percent slopes	25.58	8.6%		Ile	95	71
54	Zook silty clay loam, 0 to 2 percent slopes, occasionally flooded	22.55	7.6%		IIw	67	64
92	Marcus silty clay loam, 0 to 2 percent slopes	13.61	4.6%		IIw	94	76
310C	Galva silty clay loam, 5 to 9 percent slopes	13.12	4.4%		IIIe	87	56
91B	Primghar silty clay loam, 2 to 5 percent slopes	9.04	3.0%		Ile	95	79
310C2	Galva silty clay loam, 5 to 9 percent slopes, eroded	6.54	2.2%		IIIe	84	54
133	Colo silty clay loam, deep loess, 0 to 2 percent slopes, occasionally flooded	5.30	1.8%		IIw	78	74
310B2	Galva silty clay loam, 2 to 5 percent slopes, eroded	4.72	1.6%		Ile	90	69
810C2	Galva silty clay loam, terrace, 5 to 9 percent slopes, eroded	3.40	1.1%		IIIe	84	54
310D2	Galva silty clay loam, 9 to 14 percent slopes, eroded	1.95	0.7%		IIIe	57	44
78C2	Sac silty clay loam, 5 to 9 percent slopes, eroded	1.83	0.6%		IIIe	82	50
Weighted Average					1.91	86.2	71.2

**IA has updated the CSR values for each county to CSR2.

*c: Using Capabilities Class Dominant Condition Aggregation Method