

Soils Map

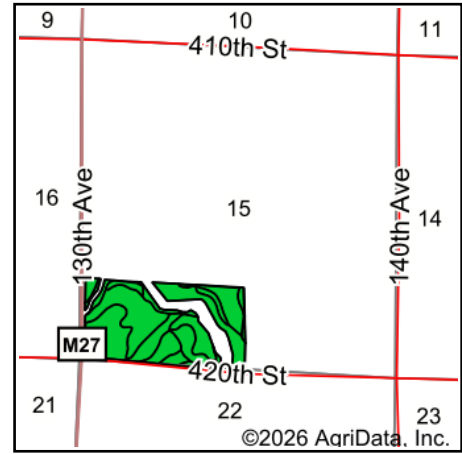
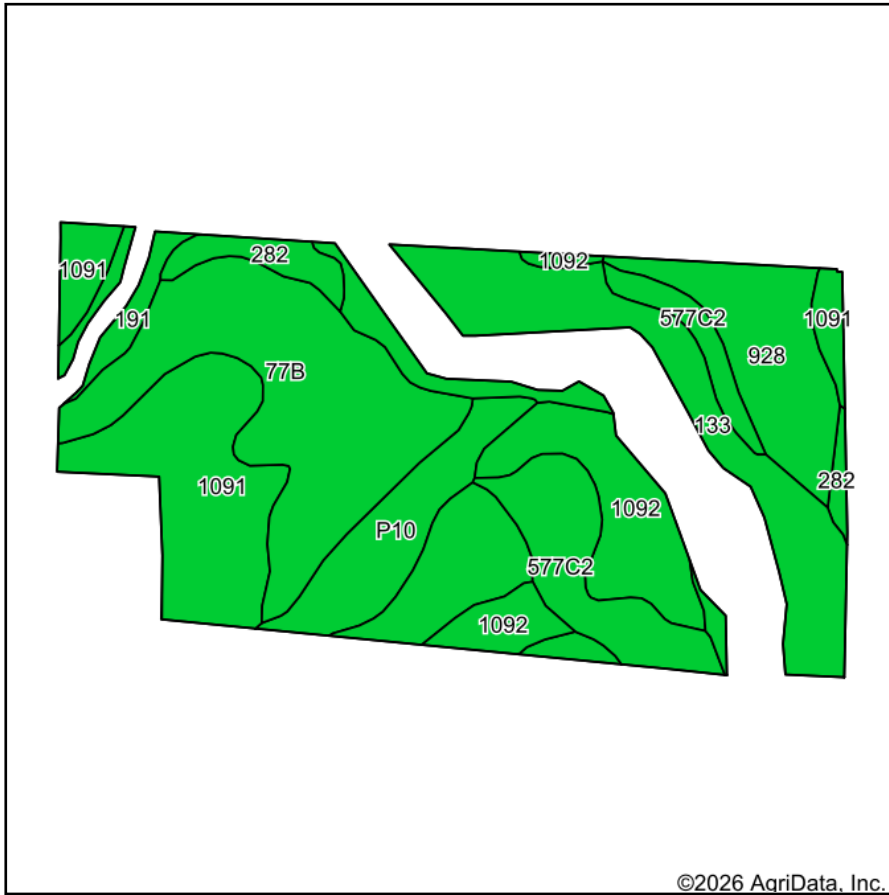

State: **Iowa**
 County: **Clay**
 Location: **15-95N-38W**
 Township: **Clay**
 Acres: **65.94**
 Date: **2/19/2026**

MIDWEST LAND & REAL ESTATE, INC
 712-262-3110 MANAGEMENT

Maps Provided By:

 CUSTOMIZED ONLINE MAPPING
 © AgriData, Inc. 2025 www.AgriDataInc.com



Soils data provided by USDA and NRCS.

Area Symbol: IA041, Soil Area Version: 35

Code	Soil Description	Acres	Percent of field	CSR2 Legend	Non-Irr Class *c	CSR2**	CSR	
1091	McCreath silty clay loam, 0 to 2 percent slopes	14.43	21.9%		lw	98	83	
77B	Sac silty clay loam, loam substratum, 2 to 5 percent slopes	13.91	21.1%		lle	95	71	
133	Colo silty clay loam, deep loess, 0 to 2 percent slopes, occasionally flooded	10.96	16.6%		llw	78	73	
1092	Gillett Grove silty clay loam, 0 to 2 percent slopes	6.71	10.2%		llw	94	78	
577C2	Everly clay loam, 5 to 9 percent slopes, moderately eroded	6.23	9.4%		llle	83	51	
928	Annieville silty clay loam, 0 to 2 percent slopes	5.80	8.8%		le	100	78	
P10	Afton silty clay loam, Sheldon creek formation, 0 to 2 percent slopes, occasionally flooded	4.57	6.9%		llw	82		
282	Ransom silty clay loam, 1 to 3 percent slopes	1.84	2.8%		lw	95	81	
191	Rushmore silty clay loam, 0 to 2 percent slopes	1.49	2.3%		llw	95	76	
Weighted Average						1.76	91.1	*-

**IA has updated the CSR values for each county to CSR2.

*- CSR weighted average cannot be calculated on the current soils data, use prior data version for csr values.

*c: Using Capabilities Class Dominant Condition Aggregation Method