

Midwest Land Management

LAND FOR SALE

Camp Township • Renville County, MN

146.5 Acres m/l



Broker's Note: This 146.5 acres m/l in Renville County, Minnesota offers a solid opportunity to own a well-managed, income-producing farm in one of southern Minnesota's proven agricultural regions. Located in Camp Township and offered through Midwest Land Management, this tract features productive farmland supported by a strong existing lease, providing immediate and reliable return for the new owner. Its manageable size makes it an attractive option for both local operators looking to add acres and investors seeking a steady, low-maintenance land investment. With quality ground, dependable income, and a desirable location, this property represents a practical and appealing addition to any farm operation or investment portfolio.

Legal Description: A parcel of land in the Southwest Quarter (SW¹/₄) of Section Sixteen (16), Township One Hundred Twelve (112) North, Range Thirty-three (33) West of the 5th PM in Renville County, MN. Exact legal to be taken from abstract.

Avg. Productivity Index: 85.5

Primary Soils: Clarion-Swanlake, Delft & Clarion-Storden

Real Estate Taxes: \$5,956

FSA Information

Cropland Acres: 135.59

Corn Base: 59.18 acres / PLC Yield: 167

Soybean Base: 53.83 acres / PLC Yield: 47

Wheat Base: .79 acres / PLC Yield: 40

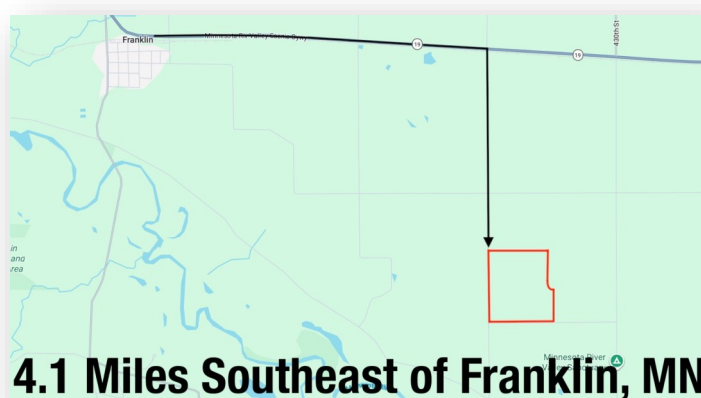

4.1 Miles Southeast of Franklin, MN

For more information contact Zach Anderson • 712-298-1606.

Price: \$1,390,000

Midwest Land Management and Real Estate, Inc.

Ben Hollesen ~ 712-253-5779 • Travis Johnson ~ 712-330-5345

Shane Brant ~ 712-301-4664 • Zach Anderson ~ 712-298-1606

Jerod Olson ~ 712-240-2800 • Jason Collins ~ 712-301-3858

Glenn Baker ~ 712-212-4417

www.midwestlandmanagement.com

& REAL ESTATE, INC
MIDWEST LAND
MANAGEMENT

Property information provided was obtained from sources deemed reliable, but the Auctioneer, Broker or Seller makes no guarantees as to its accuracy. All prospective buyers are urged to fully inspect the property, its conditions and to rely on their own conclusions. All sketches, dimensions and acreage figures in this information are approximate or "more or less". Average CSR information was obtained from Surety/Agri Data. Any announcements made the day of the sale shall supersede any previous information or oral statements. Midwest Land Management and Real Estate, Inc., affiliated licensees and the Auctioneer represent the Sellers exclusively.