

Soils Map

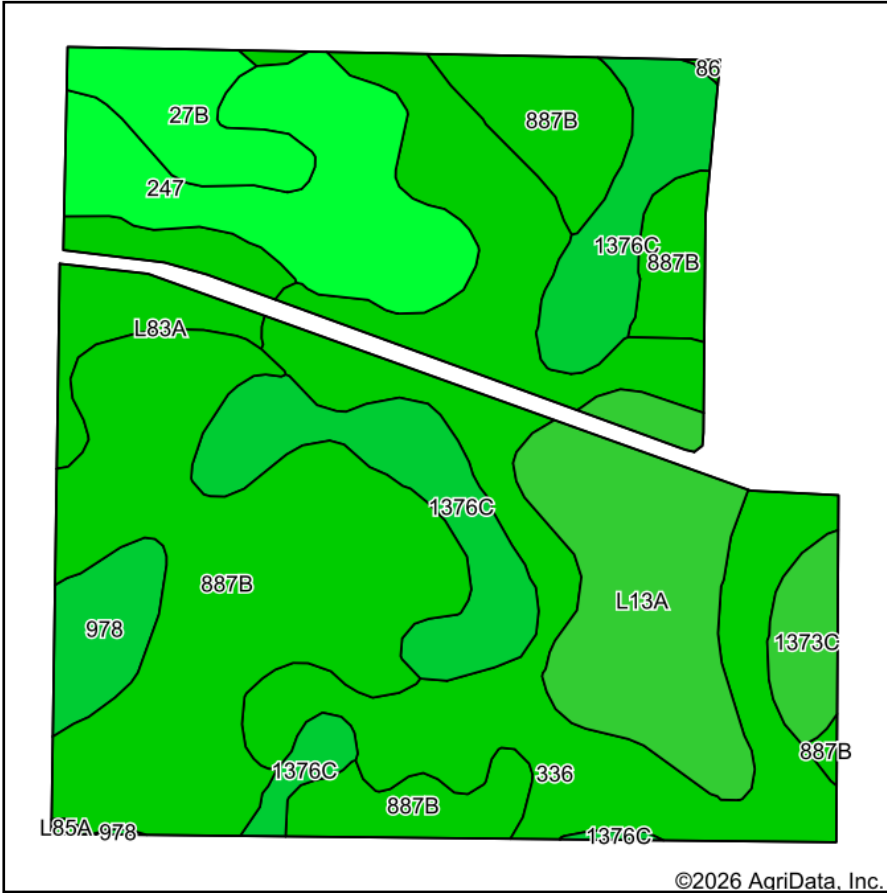

Soils data provided by USDA and NRCS.

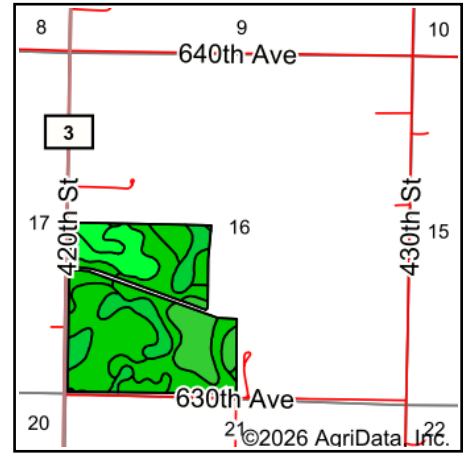

State: **Minnesota**
 County: **Renville**
 Location: **16-112N-33W**
 Township: **Camp**
 Acres: **135.59**
 Date: **3/16/2026**

712-262-3110
MIDWEST LAND & REAL ESTATE, INC.
 MANAGEMENT
 Maps Provided By:

 CUSTOMIZED ONLINE MAPPING
 © AgriData, Inc. 2025 www.AgriDataInc.com



Area Symbol: MN129, Soil Area Version: 22

| Code | Soil Description | Acres | Percent of field | PI Legend | Non-Irr Class *c | Productivity Index |
|-------------------------|--|-------|------------------|-----------|------------------|--------------------|
| 887B | Clarion-Swanlake complex, 2 to 6 percent slopes | 40.59 | 29.9% | | Ile | 92 |
| 336 | Delft clay loam, 0 to 2 percent slopes | 33.45 | 24.7% | | IIw | 94 |
| 1376C | Clarion-Storden complex, 6 to 10 percent slopes, moderately eroded | 16.14 | 11.9% | | IIIe | 87 |
| L13A | Klossner muck, 0 to 1 percent slopes | 14.89 | 11.0% | | IIw | 77 |
| 247 | Linder loam, 0 to 2 percent slopes | 12.99 | 9.6% | | IIs | 60 |
| L83A | Webster clay loam, 0 to 2 percent slopes | 5.62 | 4.1% | | IIw | 93 |
| 27B | Dickinson loam, 2 to 6 percent slopes | 5.05 | 3.7% | | IIIe | 60 |
| 978 | Cordova-Rolfe complex, 0 to 2 percent slopes | 3.75 | 2.8% | | IIw | 86 |
| 1373C | Clarion-Storden-Pilot Grove complex, 6 to 10 percent slopes, moderately eroded | 2.90 | 2.1% | | IIIe | 73 |
| L85A | Nicollet clay loam, 1 to 3 percent slopes | 0.11 | 0.1% | | Iw | 99 |
| 86 | Canisteo clay loam, 0 to 2 percent slopes | 0.10 | 0.1% | | IIw | 93 |
| Weighted Average | | | | | 2.29 | 85.5 |

*c: Using Capabilities Class Dominant Condition Aggregation Method